

TULLAHASSEE WAGONER COUNTY OKLAHOMA

Scale 1" = 150'

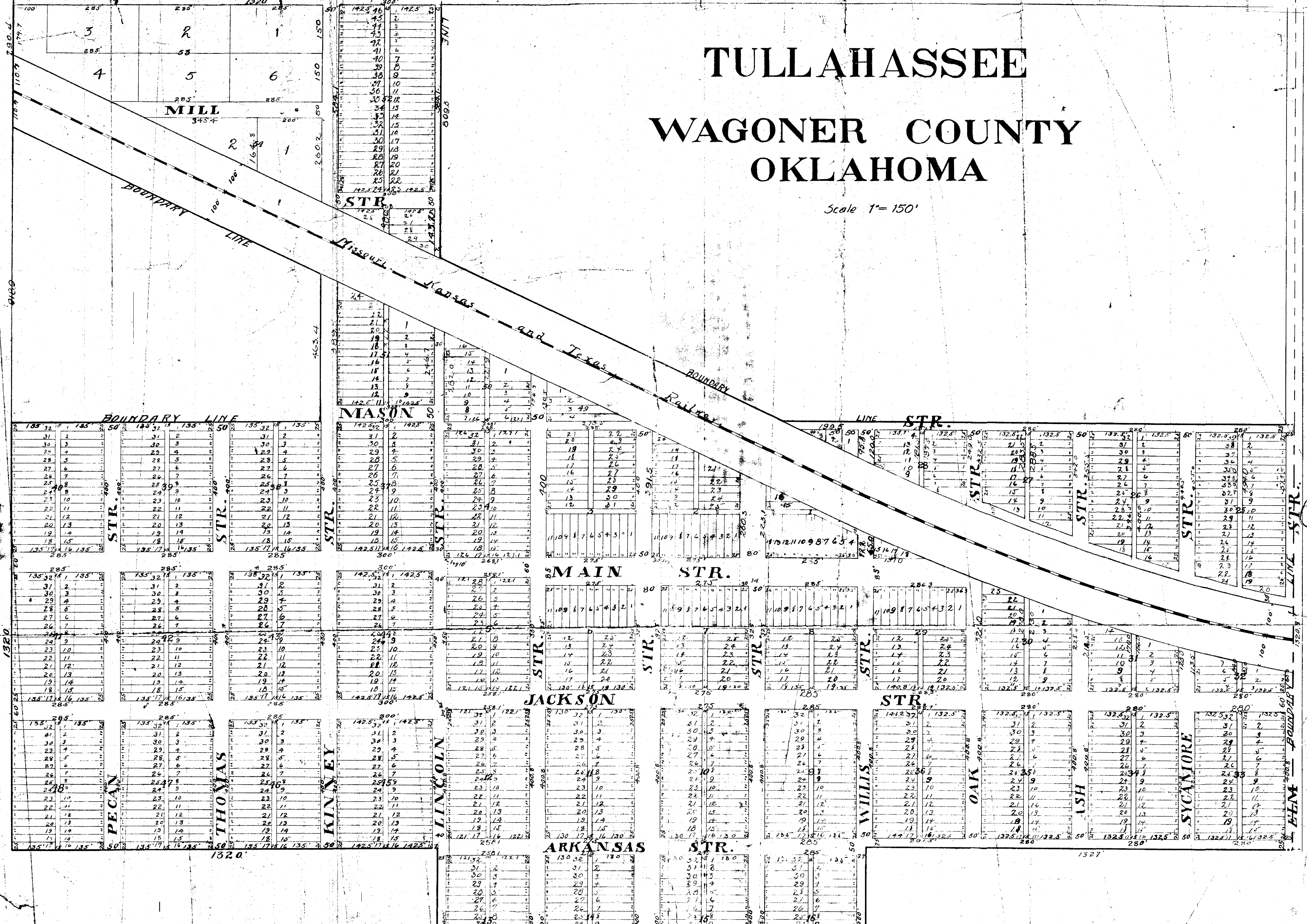

This is to certify that I, the undersigned Civil Engineer and County Surveyor of Wagoner County, Oklahoma, have carefully plotted the above map of the town of Tullahassee from the several maps now on record in the office of Register of Deeds, showing the correction of width of railroad right-of-way, together with all lots and blocks, streets and alleys and dimensions thereof.

Signed *Arthur H. Hillman*
July 6, 1914.

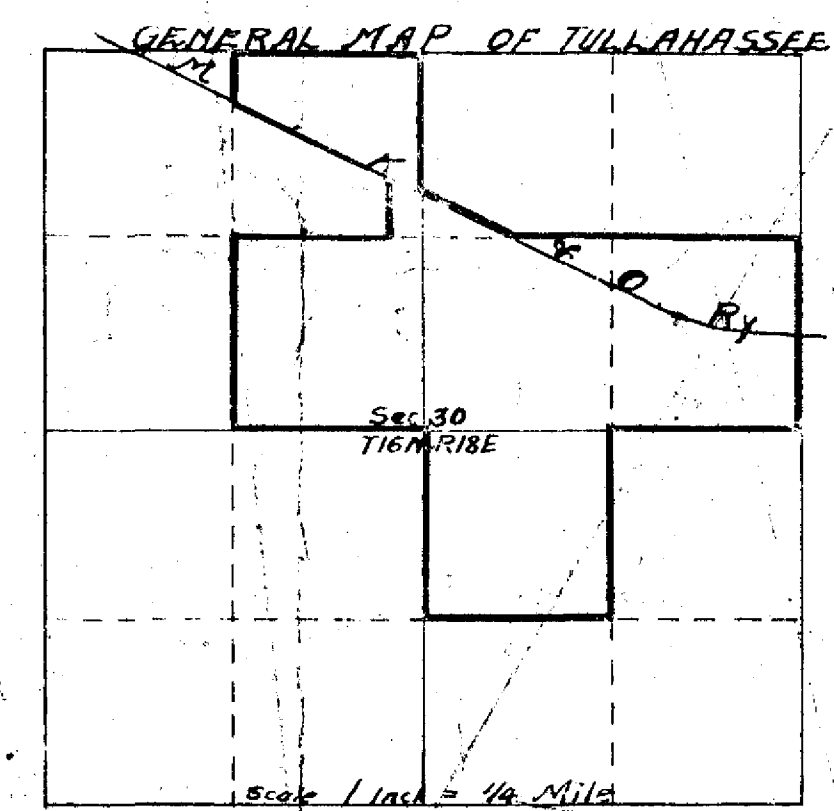

State of Oklahoma,
County of Wagoner, ss.

Before me, a Notary Public in and for said County and State on this 8th day of August, 1914, personally appeared H. H. Hillman, to me known to be the identical person who executed the certificate on the attached plat of the Town of Tullahassee, Oklahoma, and acknowledged to me that he executed the same as his free and voluntary act and deed for the uses and purposes therein set forth.

Witness my hand and official seal this 8th day of August, 1914.

Arthur H. Hillman
Notary Public
My Commission expires Dec. 22, 1915.