

Capital Surveying Inc.
 2240 South 283rd East Avenue
 Broken Arrow, Oklahoma 74014 (918) 379-6909

MEMBER
 ACSM
 OSLs
 FAX (918) 266-9862

2006-19059 Book: 1635 pg. 22
 12/14/2006 9:16 AM pgs. 22 - 22
 Fees: \$72.00 Doc: \$0.00
 Carolyn M. Kusler, County Clerk
 Wagoner County - State of Oklahoma

PLC-1-46B

RALEIGH WAITES

A SUBDIVISION WITHIN THE SE/4 OF THE NE/4
 OF SECTION 11, T-17-N, R-15-E,
 WAGONER COUNTY, STATE OF OKLAHOMA

21 LOTS, MINIMUM SIZE 1.00 ACRES

OWNER: RELIABLE DEVELOPERS, INC.
 P.O. BOX 745, COWETA, OK 74429

XXXXX = STREET ADDRESS
 B/L = BUILDING LINE
 U.E. = UTILITY EASEMENT
 D.E. = DRAINAGE EASEMENT
 SET CAPPED 3/8" IRON PIN
 AT ALL LOT CORNERS

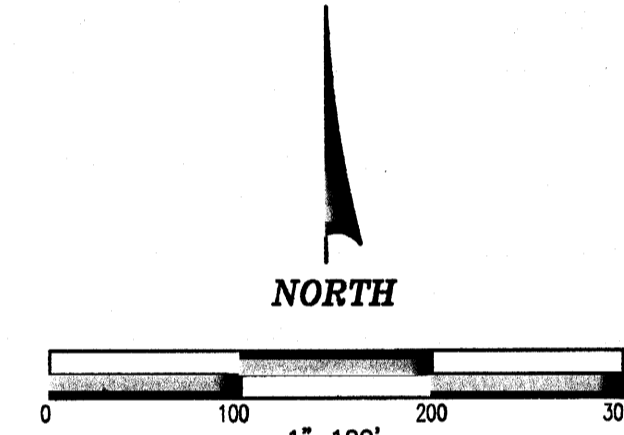
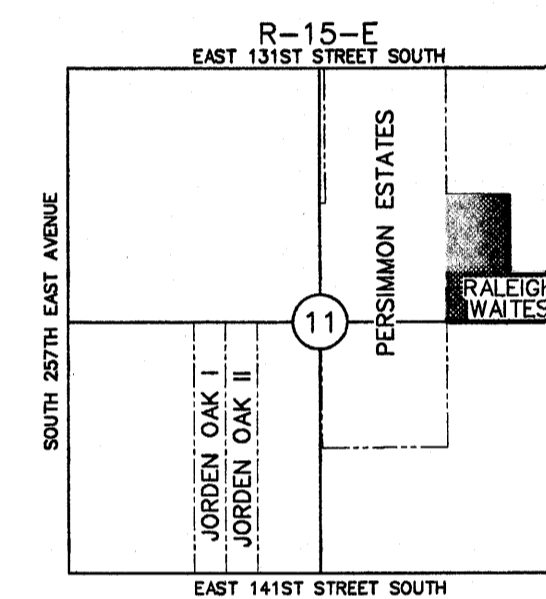

VICINITY MAP
 1"=2000'

FLOOD PLAIN NOTES
 PROPERTY DESCRIBED HEREON IS IN FLOOD HAZARD AREA 'X'-UNSHADED PER F.I.R.M. COMMUNITY PANEL NO. 400215-0041B, EFFECTIVE DATE: DECEMBER 2, 1988.

ENGINEER:
 GEORGE E. DAY, JR., P.E.
 16771 S. 253RD E. AVE.,
 COWETA, OK 74429
 918-857-5245

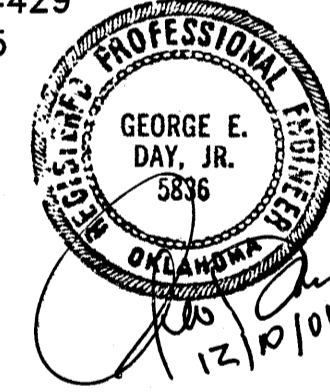

ROADS WILL BE MAINTAINED BY WAGONER COUNTY

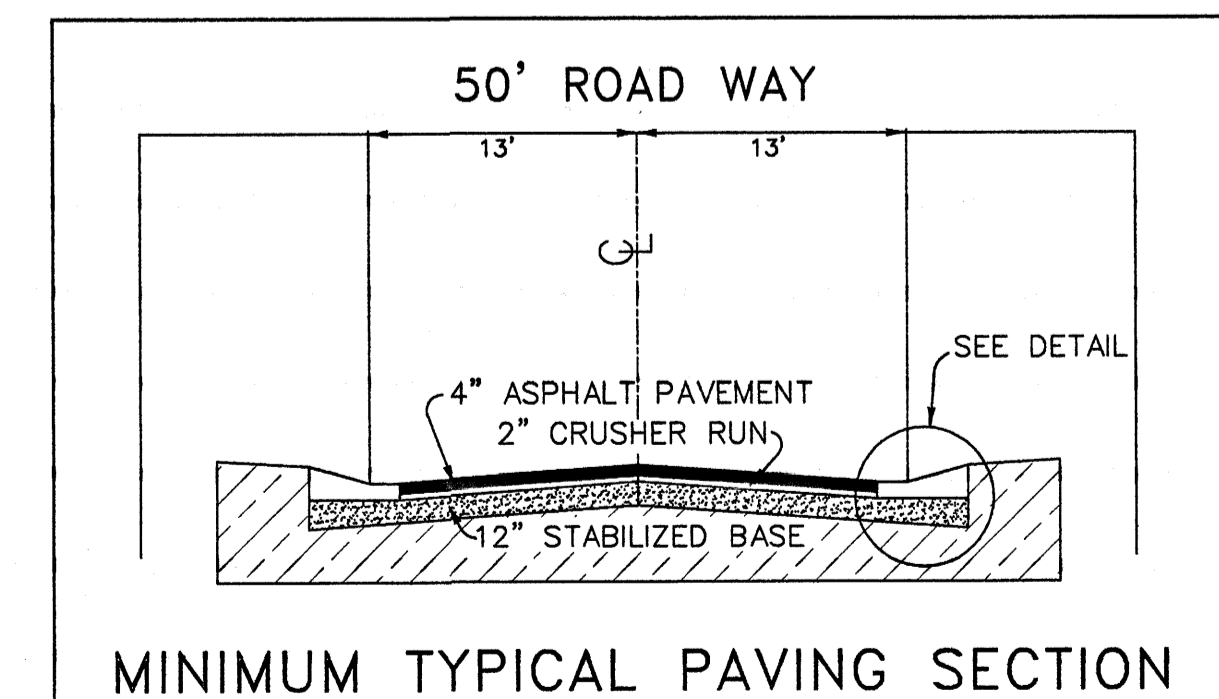
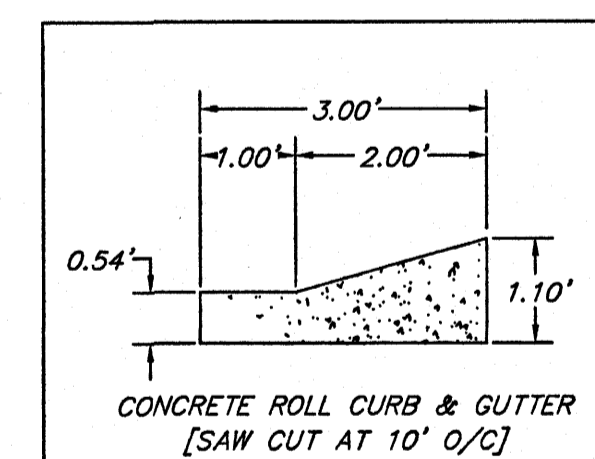

Certified True Copy
 CAROLYN KUSLER, COUNTY CLERK
 Wagoner County, Okla.
 By *Kristy Casimiro*
 DEPUTY

ISSUE DATE: DECEMBER 5, 2006

