

FORT GIBSON RESERVOIR
RAINBOW END

SCALE: 1" = 60'

ENGINEERS CERTIFICATE

I, James E. Curry, the undersigned, a duly registered Professional Engineer in the State of Oklahoma, do hereby certify that I have accurately platted the following described property: A portion of the W 1/2 NE 1/4 of Section 17, more particularly described as follows: Beginning at the NE Cor. SE 1/4 SE 1/4 NW 1/4 of said Section 17, thence N 00° 02' E 90.2 feet; thence S 74° 25' E 99.75 feet; thence N 67° 09' E 96.42 feet; thence N 44° 56' W 47.17 feet; thence N 13° 00' W 261.8 feet; thence N 4° 27' W 171.92 feet; thence N 12° 55' W 151.7 feet; thence N 19° 24' E 130.37 feet; thence N 54° 29' E 192.15 feet; thence N 70° 09' E 233.75 feet; thence S 81° 10' E 199.12 feet to the point of intersection with the East line of the property; thence South, along said East line, 994.25 feet; thence N 89° 45' W 662.39 feet to the point of beginning. All in Section 17, T 17 N, R 19 E, Wagoner County, Oklahoma, and containing 13.42 Acres, more or less. Said tract being known as RAINBOW END (Clubsite No. 7) a subdivision of a portion of W 1/2 NE 1/4 Section 17.

Witness my hand and seal this 22 day of October 1964.

James E. Curry
 James E. Curry, Engineer

Subscribed and sworn to before me this 22 day of October 1964.

My commission expires: July 19, 1965

Reynold P. Morris
 Notary Public

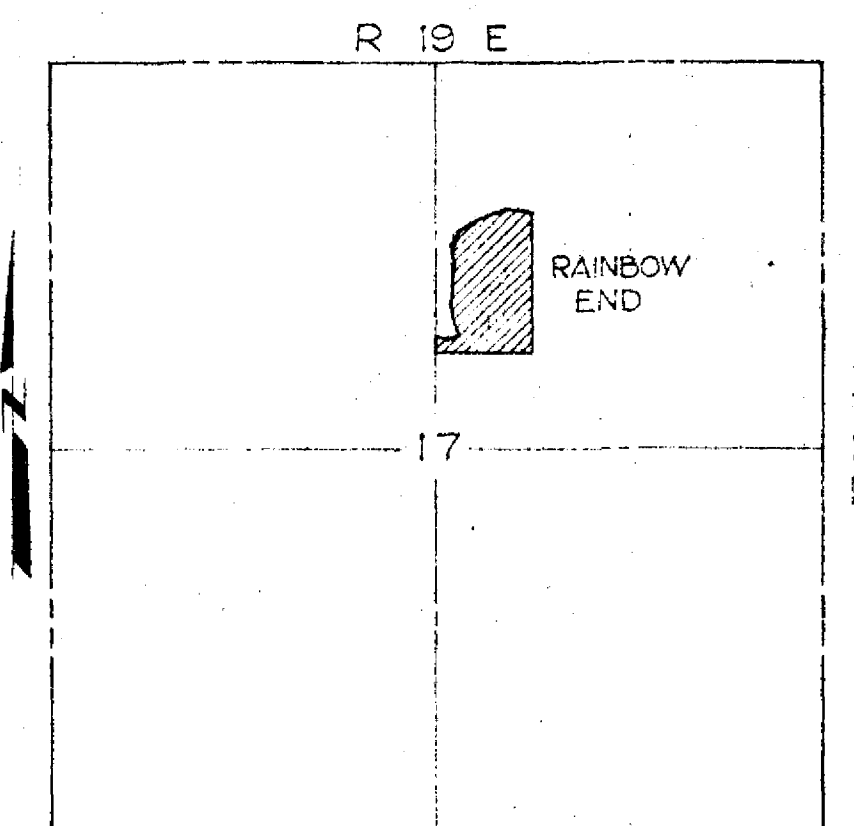

VICINITY MAP
 Scale: 4" = 1 Mile

I hereby certify that all taxes, including the 1964 taxes, have been paid in full, according to records in the office of the Wagoner County Treasurer
Eric P. Miller, Co. Treas.