

1975.8

General Map

All alleys are 20 feet wide.

Amended and Corrected Plat  
of  
**PORTER**  
Creek Nation.  
Ind. Ty

Scale of Feet  
0 100 200 300 400 500

I hereby certify that this is a correct plat of the town of Porter as surveyed by me.

R.H. Kello. C.E.

Muskogee, I.T.  
3/6/05.

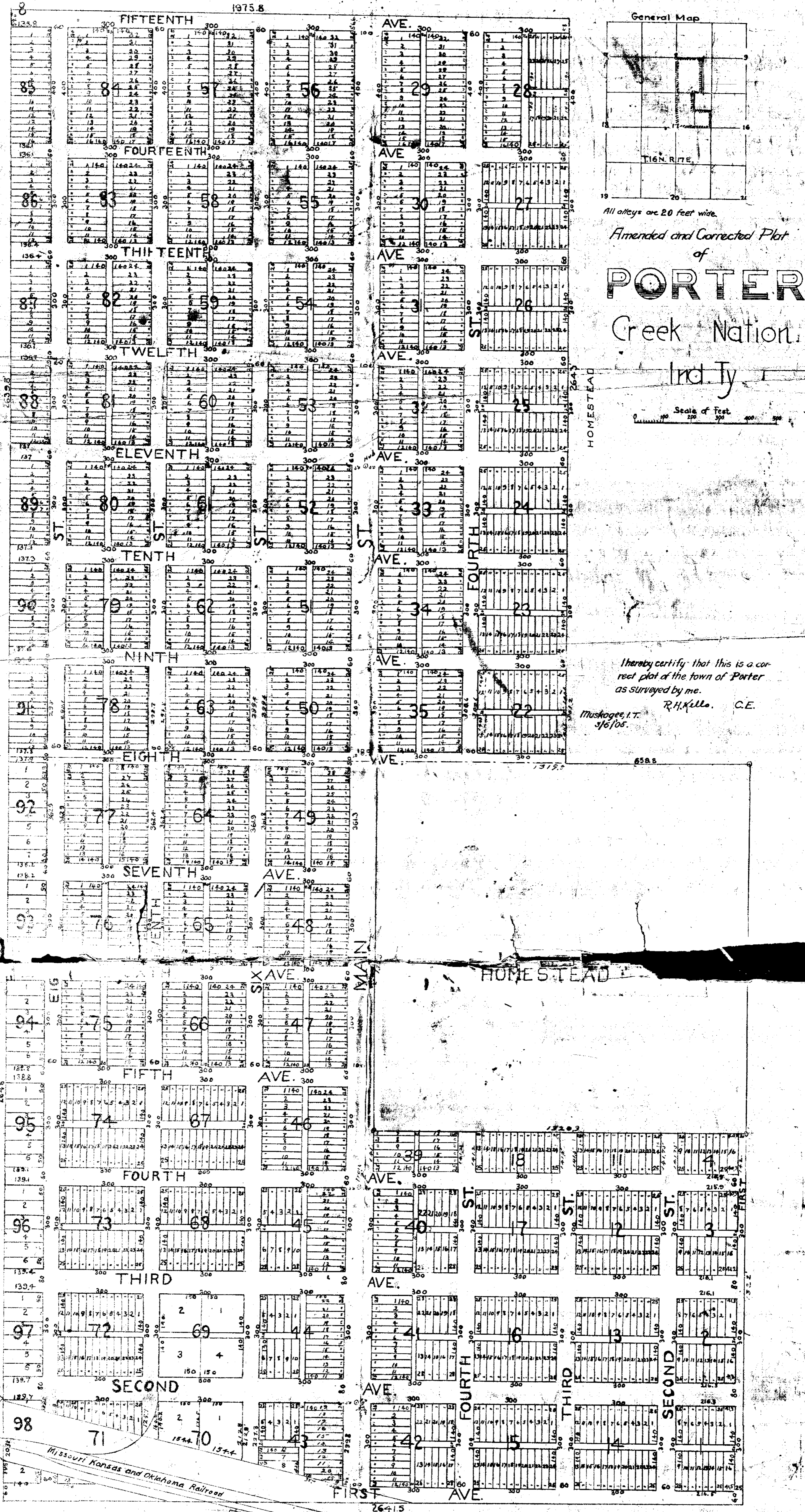

Missouri Kansas and Oklahoma Railroad

Station  
Stock Yards  
Elevator