

SOUTH ADDITION TO
PORTER
 OKLAHOMA

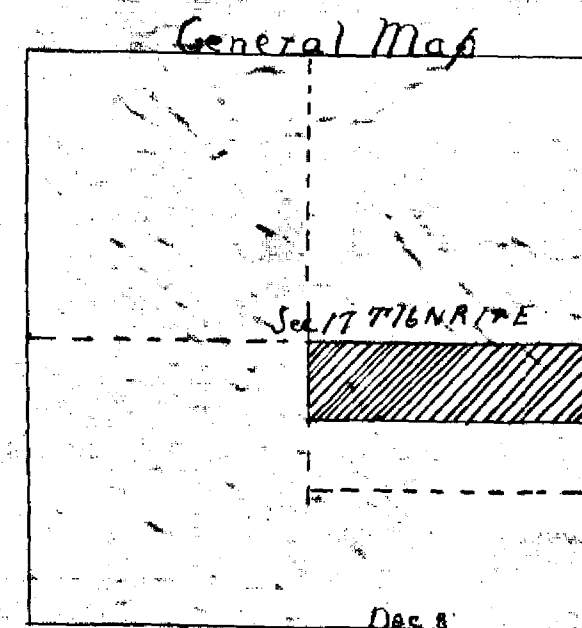

Description
 N43¹/₂ Acres of the N¹/₂
 of the SE¹/₄ of Sec 17
 T 16 N. R 17 E.

I hereby certify that this is
 a correct plat of the South Addition
 to the Town of PORTER, Ok. as surveyed
 by me
Jamies J. Gates
 Co. Surveyor
 Wagoner Ok

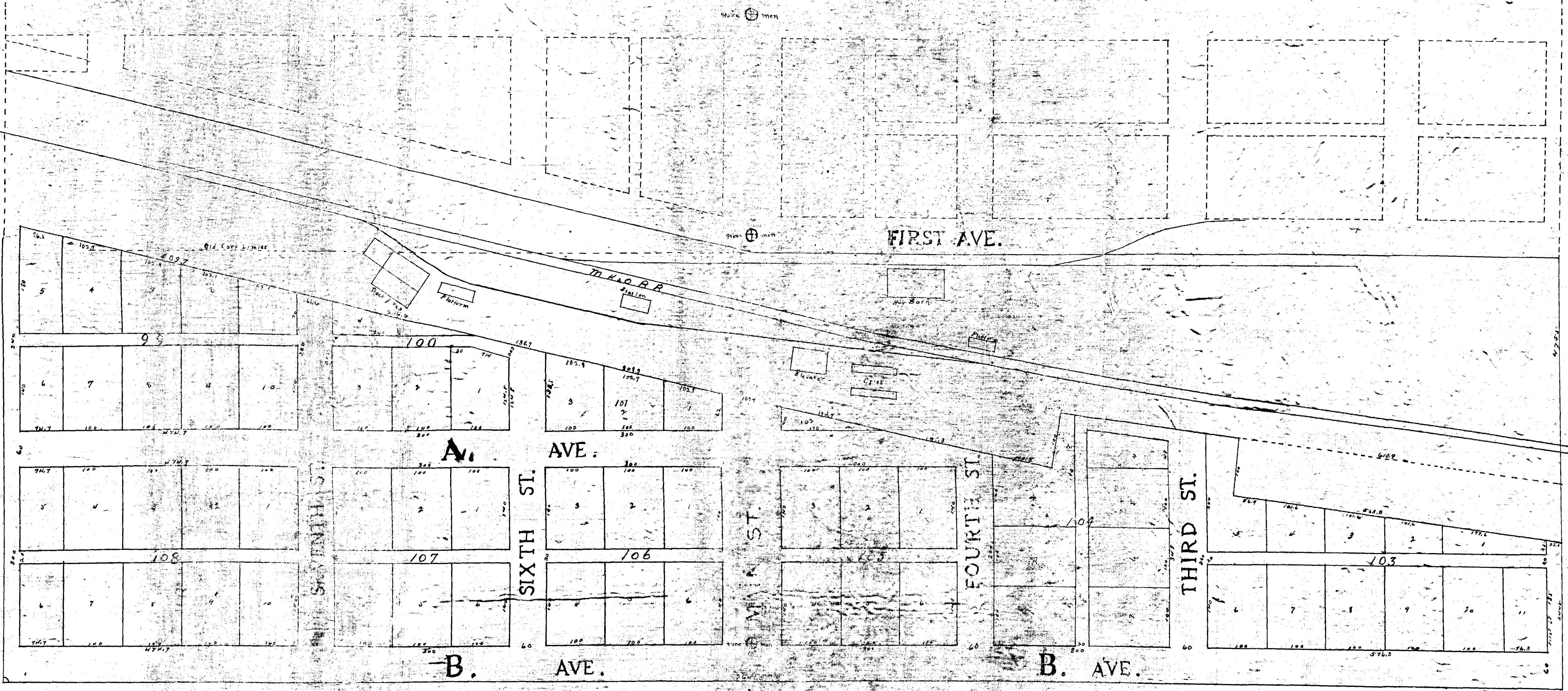

May 14-1909
J. W. Rulle