

PARK VIEW

ADDITION TO WAGONER OKLA.

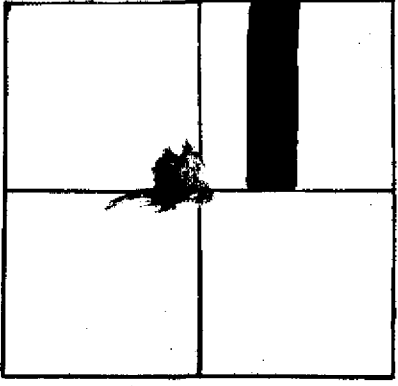

Description
The East 1/2 of
the West 1/2 of the NE 1/4
of Sec. 14 Twp 17 North
Range 18 East

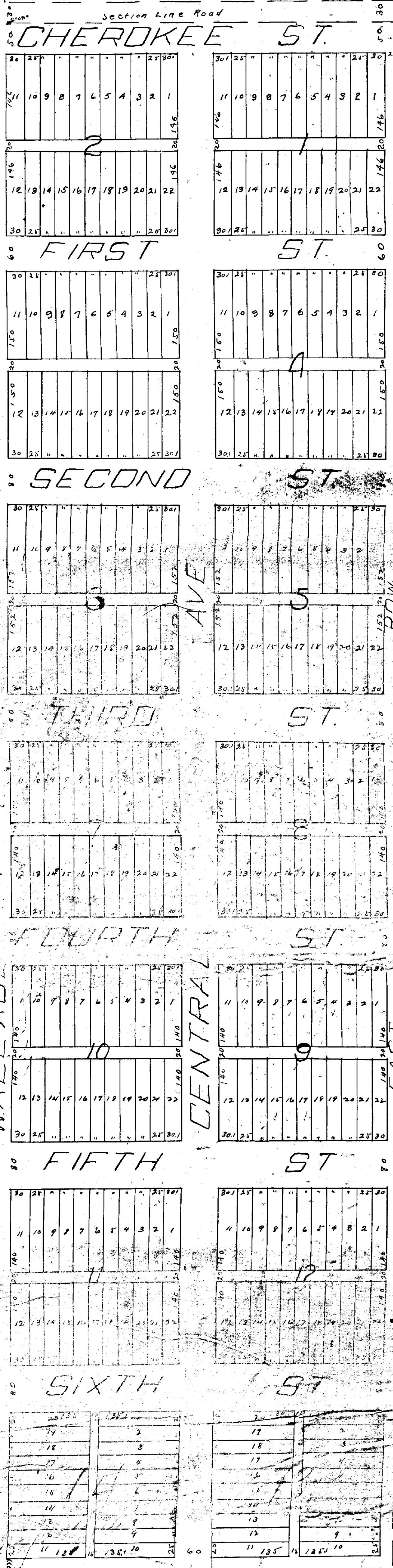

Aug 30-1906
J. W. Riddle

STATE OF OKLAHOMA, COUNTY OF WAGONER, SS.
I, Evie P. Miller, hereby certify that I am the duly elected, qualified and acting County Treasurer of the County of Wagoner, Oklahoma; that all taxes for the year 1955 and for all prior years assessed against the West Half of the Northeast Quarter of the Southwest Quarter of Section 17, Township 17 N., Range 19 E., Wagoner County, Oklahoma, have been paid in full. DATED this 18 day of July, 1956.

Before me, a Notary Public, in and for said County and State, on this 14 day of July, 1956, personally appeared Evie P. Miller to me known to be the duly elected, qualified, and acting County Treasurer of the County of Wagoner, Oklahoma, and the identical person who executed the within and foregoing instrument, and acknowledged to me that she executed same in her capacity as County Treasurer of Wagoner County, Oklahoma, as her free and voluntary act and deed, and as the free and voluntary act and deed as such County Treasurer of Wagoner County, Oklahoma for the uses and purposes therein set forth.

EVIE P. MILLER
Notary Public

Scale 100' = 1 inch

We hereby certify that we have correctly surveyed the above plat and that the above plat is correct

MANLOVE & HASKELL
ENGRS
Muskogee OKLA.

PLAT
SUBDIVISION