

COPPER FOX ADDITION PHASE I

A SUBDIVISION OF A PART OF THE SE/4 OF SECTION 6,
T-18-N, R-16-E, OF THE I.B. & M., WAGONER COUNTY,
STATE OF OKLAHOMA, ACCORDING TO THE U.S.
GOVERNMENT SURVEY THEREOF.

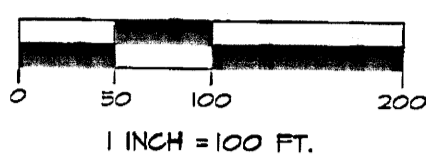
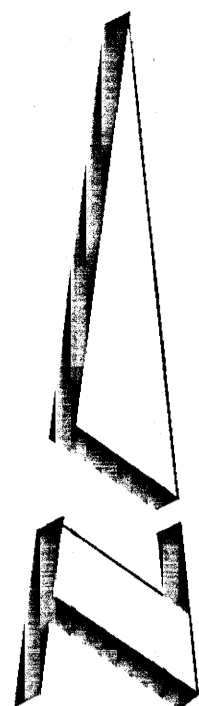

ALL BUILDING LINES SHOWN ARE
THIRTY-FIVE FEET.
SET 3/8" IRON PINS W/ YELLOW CAPS
STAMPED "PLS 1056" AT ALL LOT CORNERS
& ALL Q P-THINGS

100 YEAR FLOOD PLAIN AS PER CORP OF
ENGINEERS DIGITAL FILE ISSUED ON
OCTOBER 3, 1996.

BASIS OF BEARINGS ARE ASSUMED

95 LOTS
79.94 ACRES

LEGEND
U/E - UTILITY EASEMENT
D/E - DRAINAGE EASEMENT
ESMT - EASEMENT

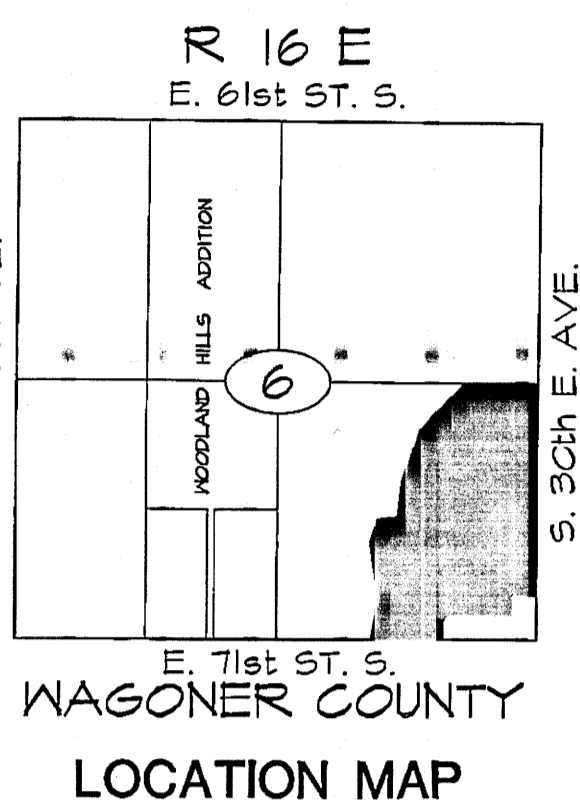

OWNER:
YORKTOWN COMPANY
BLYTHE CARNEY
3515 SOUTH YORKTOWN PLACE
TULSA, OKLAHOMA 74105
(918) 744-7333

SUBDIVIDER:
VOYLES CONSTRUCTION COMPANY
ROUTE 1 BOX 729
WAGONER, OKLAHOMA 74467
(918) 462-1107
AND
YORKTOWN COMPANY
BLYTHE CARNEY
3515 S. YORKTOWN PLACE
TULSA, OKLAHOMA 74105
(918) 744-7333

SURVEYOR:
PROFESSIONAL SURVEYING, INC.
1523 SOUTH HARVARD AVENUE, SUITE 204
TULSA, OKLAHOMA 74112-5834
(918) 744-5252

ENGINEER:
JOE E. DONELSON
17440 SOUTH 89TH EAST AVENUE
BIXBY, OKLAHOMA 74008
(918) 366-3413

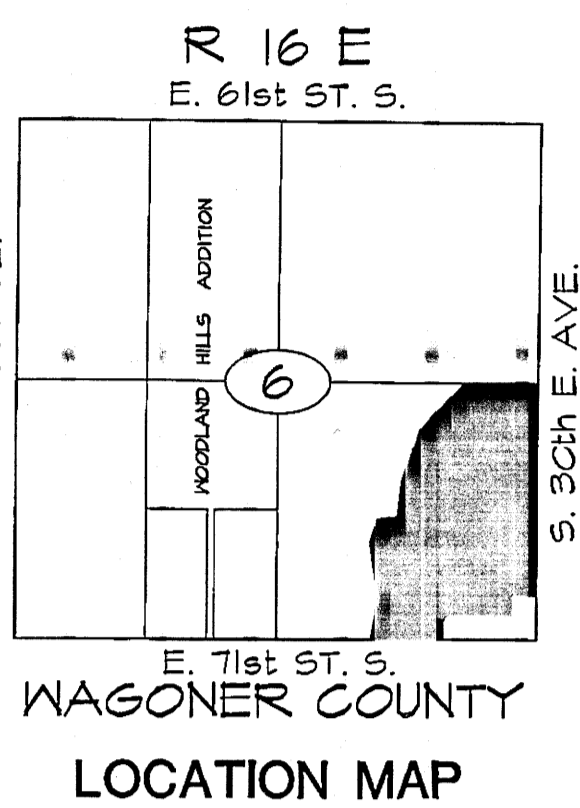

OWNER:
YORKTOWN COMPANY
BLYTHE CARNEY
3515 SOUTH YORKTOWN PLACE
TULSA, OKLAHOMA 74105
(918) 744-7333

SUBDIVIDER:
VOYLES CONSTRUCTION COMPANY
ROUTE 1 BOX 729
WAGONER, OKLAHOMA 74467
(918) 462-1107
AND
YORKTOWN COMPANY
BLYTHE CARNEY
3515 S. YORKTOWN PLACE
TULSA, OKLAHOMA 74105
(918) 744-7333

SURVEYOR:
PROFESSIONAL SURVEYING, INC.
1523 SOUTH HARVARD AVENUE, SUITE 204
TULSA, OKLAHOMA 74112-5834
(918) 744-5252

ENGINEER:
JOE E. DONELSON
17440 SOUTH 89TH EAST AVENUE
BIXBY, OKLAHOMA 74008
(918) 366-3413



S 00°16'54" E 2145.10'
SO. 305th EAST AVE.