

Directions: On 141st Street (Coweta Road) two and three-tenths miles east of County Line Road beside Shahan Free Will Baptist Church.

History: Cemetery rows listed were read starting on the west side and read from south to north direction.

Status: Active, fenced and maintained. Last surveyed in 2014.

Contact: Mary Arzella Buchanon, 5648 S. 33rd W. Ave, Tulsa, OK 74107; Phone: 918-289-0554

Map:

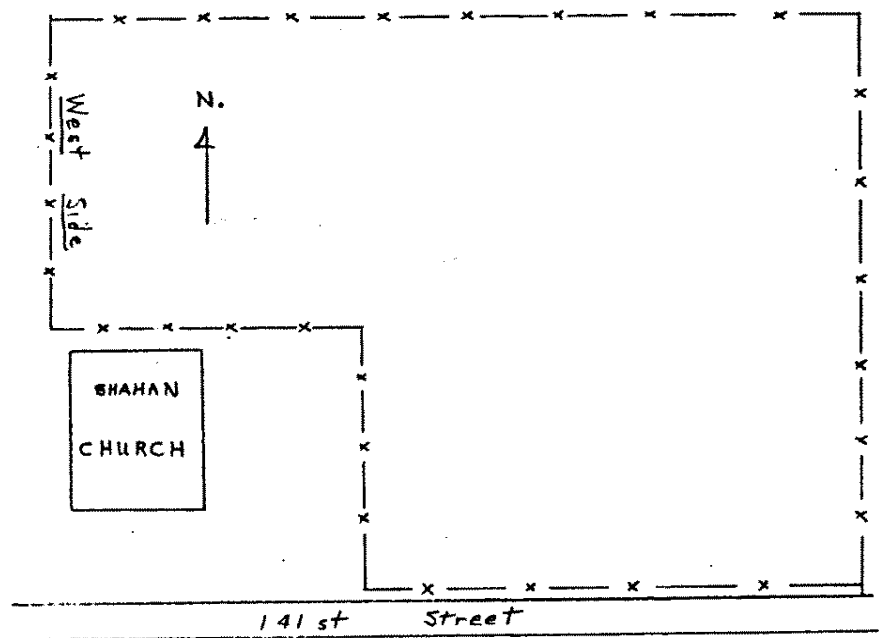

Last Name	First Name	Middle	Date of Birth	Date of Death	Marriage Date	Sec	Blk/Row	Lot	Campaign	Branch	Remarks
A							22	11			Field stone
Adams	John		2/17/1906	6/7/1907			36	5			Son of J.G.; Verse at bottom

Shahan Cemetery
S9, R15E, T17N, Shahan Township

Last Name	First Name	Middle	Date of Birth	Date of Death	Marriage Date	Sec	Blk/Row	Lot	Campaign	Branch	Remarks
Alan	Elizabeth	May	5/1/1886	3/3/1971			10	5			Loving Aunt
Alexander	Little	Nellie	9/28/1903	10/12/1906			36	6			
Anderson	Homer		6/5/1917	6/27/1918			31	7			Son of W.H. and Ollie; Our darling baby; verse at bottom
Baker	Charley	A.	4/4/1890	6/18/1958			20	17			
Baker	George	W.	1856	1923			20	19			
Baker	Loman	S.	11/21/1911	1/26/1912			35	5			Son of M.A. and G.M.; Peace perfect peace
Baker	Mary	M.	1858	1941			20	18			
Barnard	Lillie	Jenkins	2/23/1890	11/7/1964			33	13			Mother
Barton	Fielden	Geno	1881	1909			38	5			crosses
Bates	Frank	L.	7/12/1870	5/16/1940			22	26			Father; Gone but not forgotten
Bates	Mattie	Fay	2/10/1928	4/30/1928			22	27			
Bates	Mattie		3/8/1883	6/17/1953			22	25			Asleep in Jesus
Bell	Dora		12/17/1870	11/11/1920			15	13			Mother
Bell	George	W.	9/27/1860	4/21/1939			15	12			Father
Bell	Harry		1894	1977	7/4/1915		6	4			Together forever; Shares stone with Ida M Bell
Bell	Ida	M.	1898	1977	7/4/1915		6	5			Vases; Shares stone with Harry Bell
Bellgraph	M.	I.	1890	1918			41	1			Only found illegible field stone marker during 2014 survey
Bellgraph							41	2			Mother; Sandstone or fieldstone used as monument; Illegible during 2014 survey
Bench	Albert		1883	1970			21	10			Papa; Oddfellows emblem; vases; Shares stone with Nora J Bench
Bench	Dorothy		7/21/1920	7/22/1920			15	14			Our beloved Daughter

Shahan Cemetery
S9, R15E, T17N, Shahan Township

Last Name	First Name	Middle	Date of Birth	Date of Death	Marriage Date	Sec	Blk/Row	Lot	Campaign	Branch	Remarks
Bench	Nora	J.	1891	1925			21	9			Mamma; Rebecca emblem; Shares stone with Albert Bench
Best	Elizabeth	C.	1848	1933			17	21			Mother They left us a wonderful pattern to live by; Shares stone with Franklin Best
Best	Franklin		1845	1933			17	20			Father; They left us a wonderful pattern to live by; Shares stone with Elizabeth C Best
Bevard	A.	J.	7/5/1951	2/4/1904			33	3			Carved field stone
Bevard	Cathy	Sue	2/4/1943	3/6/1943			35	14			
Bevard	Joe	U.	8/18/1888	4/9/1953			35	16			Homemade concrete marker
Bevard	Maggie		6/26/1890	10/1/1962			35	17			Mother
Bevard	Olen		9/29/1912	6/28/1980			35	19			
Bevard	Olen		9/29/1912	6/28/1980			36	8			
Bevard	Pearl						33	4			Carved field stone
Bevard			3/4/1853	8/9/1938			35	12			Mother; Homemade concrete marker
Bevard							38	8			Not found during 2014 survey
Blair	D.						37	7			Carved field stone
Blair	Meevil			7/23/1906			37	8			Carved field stone
Booth	Shirley	E.	6/9/1953	6/9/1953			21	7			
Bowers	Earl	Wayne	2/2/1932	5/5/1966			28	15	WWII		Oklahoma, SGT, HQ CO. 1 CORPS; Veteran stone
Bowers	Gladys	Irene	5/9/1907	11/6/1984			28	12			Shares stone with John Wesley Bowers
Bowers	Jo		8/16/1939	3/31/2006			3	9			Vase in center with B; shares stone with Sam R Bowers
Bowers	Joe	DeWitte	7/14/1944	4/5/1951			28	10			Vase
Bowers	John	Wesley	6/6/1902	8/17/1957			28	13			Vases; shares stone with Gladys Irene Bowers

Shahan Cemetery
S9, R15E, T17N, Shahan Township

Last Name	First Name	Middle	Date of Birth	Date of Death	Marriage Date	Sec	Blk/Row	Lot	Campaign	Branch	Remarks
Bowers	Sam	R.	5/24/1940	12/13/1975			3	8			Vases with B; Shares stone with Jo Bowers
Bowman	W.	M.	4/22/1885	7/14/1934			28	9			Not found during 2014 survey
Boyd	Golden		8/2/1904	8/30/1910			35	9			
Boyd	Jessie		8/11/1909	4/27/1910			35	8			
Brown	Cora	B.	1895	1979			14	4			Shares stone with William W Brown
Brown	Floyd		1906	1969			5	1			In loving memory of; angel; Marker is in the form of a bench; Shares with Opal Potter
Brown	William	W.	1890	1957			14	3			Shares stone with Cora B Brown
Bruce	Andrew	M.	10/29/1889	6/2/1960			12	8			Shares stone with Icy Pearl Bruce
Bruce	Icy	Pearl	2/20/1894	8/20/1968			12	9			Shares stone with Andrew M Bruce
Bruce			2/18/1924	7/21/1924			18	2			At rest
Bryan	Jearldene		1937	1937			27	9			Homemade concrete marker
Bryan	Lester		4/22/1914	7/6/1984			1	2			Shares stone with Pearl Bryan
Bryan	Pearl		4/3/1904	11/13/1987			1	3			Shares stone with Lester Bryan; Vase in center
C.L.							20	9			Rock marker
C.L.J.							22	10			Field stone
Campbell	Earnest	S.	5/5/1911	6/12/1974			8	11			Shares stone with Viola Mae Campbell
Campbell	Joyce	Fern	1933	1933			24	11			Homemade concrete marker
Campbell	Joyce	G.	10/14/1932	6/6/1966			7	1			Cross
Campbell	Linda	J.	8/17/1959	3/5/1960			8	1			
Campbell	Serviller	H.	10/14/1884	1/20/1976			10	21			Shares stone with Thomas H Campbell

Shahan Cemetery
S9, R15E, T17N, Shahan Township

Last Name	First Name	Middle	Date of Birth	Date of Death	Marriage Date	Sec	Blk/Row	Lot	Campaign	Branch	Remarks
Campbell	Thomas	H.	11/3/1887	12/13/1973			10	20			Shares stone with Serviller H Campbell
Campbell	Viola	Mae	9/22/1912	4/24/1978			8	12			Shares stone with Earnest S Campbell
Carner	G.	R.	1871	1962			14	5			Shares stone with Josie Carner
Carner	Ivan		4/13/1900	9/16/1981			10	16			
Carner	J.	Evert	2/9/1901	6/7/1902			22	1			Infant son of G.R. and I.
Carner	Jane		5/3/1837	5/3/1914			22	5			At rest; Verse at bottom
Carner	Josie		1881	1965			14	6			Shares stone with G R Carner
Carner	Miril			6/10/1902			22	4			Infant son; Field stone
Carner	Ted		12/19/1905	2/6/1964			10	15			
Carter	Altha	M Townsley	2/23/1915	7/14/1996			11	3			Shares stone with Charles Travis Carter
Carter	Bessie	T.	8/7/1894	6/27/1971			7	3			Mother; Shares stone with Leslie C Carter
Carter	Charles	Travis	10/26/1913				11	2			Vase in center with C; shares stone with Altha M Townsley Carter
Carter	James	Bryan	2/1/1938	12/21/2001			11	1			Son, Brother, Dad; Forever in our hearts; Vase; Crosses
Carter	Kathy	R.	2/13/1964	1/25/2005			4	2			Daughter; In loving memory; vases
Carter	Leslie	C.	11/3/1884	2/1/1973			7	2			Father; Vase in center; Shares stone with Bessie T Carter
Carter	W.	G.	1932	1932			19	10			Homemade concrete marker
Carver	Bertha	D.	2/28/1892	9/1/1987			12	23			Praying hands; Shares stone with Roy D Carver
Carver	Roy	D.	8/24/1888	9/26/1964			12	22			Into Thy hands I commend my spirit; Shares stone with Bertha D Carver
Casebolt	Emily	Alice	6/18/1865	10/7/1967			13	33			Mother; They lived their life for Christ
Casebolt	Rev. James	Franklin	4/22/1851	4/6/1927			13	34			Father of Mary Jane (Casebolt) Lamberson

Shahan Cemetery
S9, R15E, T17N, Shahan Township

Last Name	First Name	Middle	Date of Birth	Date of Death	Marriage Date	Sec	Blk/Row	Lot	Campaign	Branch	Remarks
Casey	Kate	V.	11/12/1887	2/28/1929			22	32			Mother; Praying hands
Casey	Walter	R.	2/11/1886	4/14/1964			8	15			Father; Praying hands
Cash	Albard	D.	11/2/1892	4/9/1906			32	4			Son of Robert and E.L.; Verse at bottom
Cash	Blanch		10/24/1910	7/1/1911			32	5			Gone but not forgotten; lamb
Chambers	Hazel	O.	1905	1971			5	13			Shares stone with Lowell H Chambers
Chambers	Lowell	H.	1905	1982			5	12			Shares stone with Hazel O Chambers
Chandler	Anne	E.	8/21/1929				5	9			Vases; Shares stone with Clayton C Chandler
Chandler	Clayton	C.	3/5/1920	9/15/1975			5	10	WWII	Army	Shares stone with Anne E Chandler; CPL; Metal veteran foot marker; cross
Chaney	Ida	L.	1/20/1895	8/3/1973			5	11			Vase
Chartier	Vivian		4/5/1893	12/26/1935			22	16			
Chissoe	Sam	W.	8/3/1903	6/18/1969			6	13			
Clark	Eligah	M.	1876	1915			37	9			Father; Precious memory
Clark	Ella		1865	1952			13	20			Shares stone with J.D. Clark
Clark	Flora		10/19/1895	4/19/1983			12	2			Mother; In loving memory
Clark	Freeman		1872	1939			20	16			Homemade concrete marker
Clark	Gertrude		6/2/1893	11/5/1926			22	14			Mother; Gone but not forgotten
Clark	J.	D.	1866	1939			13	19			Shares stone with Ella Clark
Clark	J.	H.	1868	1935			20	14			Homemade concrete marker
Clark	Jennie		1899	1906			37	5			Homemade concrete marker
Clark	Marshall		5/29/1892	3/20/1963			12	1			Father

Shahan Cemetery
S9, R15E, T17N, Shahan Township

Last Name	First Name	Middle	Date of Birth	Date of Death	Marriage Date	Sec	Blk/Row	Lot	Campaign	Branch	Remarks
Clark	Norma	June	1932	1936			15	19			
Clark	Walter		1903	1910			37	6			Homemade concrete marker
Claxton	Chloe	Ann	11/25/1887	6/23/1936			25	13			Mother; At rest
Claxton	Eula	C.	1898	1996			10	2			Mother; Shares stone with Harvie L Claxton
Claxton	Harvie	L.	1891	1967			10	3			Father; Shares stone with Eula C Claxton
Claxton	Norman	Dale	8/16/1931	8/24/1962			10	1			Oklahoma A2C 96 Tactical Hosp AF; cross; Metal veteran marker
Cole	Allen	W.	11/11/1953	2/3/1954			31	14			Son; In God's Care
Cole	Alta	A.	1897	1962			9	3			Mom; Shares stone with Bennie G Cole
Cole	Bennie	G.	1895	1982			9	4			Dad; crosses; Shares stone with Alta A Cole
Cole	Diccie	Jewell	1/5/1922	3/26/1995			9	5			
Cole	Jackie	W.	11/9/1933	11/16/1933			22	24			Son
Cole	Jaunita (sic)		1/17/1921	4/26/1934			23	2			Homemade concrete marker
Cole	Leota	M.	11/20/1932				4	6			Wife; Vases; Photo; Shares stone with Wesley Green Cole
Cole	Mary	E.	1866	1931			22	21			Mom
Cole	Mrs.						23	5			Illegible marker
Cole	Wesley	Green	3/1/1926	6/9/1972			4	5	WWII	Army Air Forces	Husband; Oklahoma, PVT, OK Sheriff and Peace Officers Assn.; Shares stone with Leota M Cole; Veteran stone lies behind head stone; cross; Also has foot stone
Cole	Willie		9/19/1889	11/7/1960			23	3			
Cole							4	7			Concrete block painted "Cole"
Cole							4	8			Concrete block painted "Cole"
Collins	Hazel		12/15/1903	5/10/1983			10	10			Shares stone with Ira Collins

Shahan Cemetery
S9, R15E, T17N, Shahan Township

Last Name	First Name	Middle	Date of Birth	Date of Death	Marriage Date	Sec	Blk/Row	Lot	Campaign	Branch	Remarks
Collins	Ira		11/8/1896	9/21/1964			10	9			Shares stone with Hazel Collins
Collins	Junior	Ray	6/9/1935	6/11/1935			28	5			Homemade concrete marker
Collins	Richard	Ira	5/18/1927	1/12/2002			2	7	WWII; Korea	Army	CPL; Metal veteran marker; cross; also has foot stone
Cooper	B.	J.	10/8/1931	1/26/1938			24	9			
Cooper	C.	N.					24	10			Only base remains
Cooper	Ethel	Mae	1897	1961			8	10			Shares stone with William M Cooper
Cooper	Henry		10/4/1886	1/12/1940			27	6			At rest
Cooper	William	M.	1887	1968			8	9			Shares stone Ethel Mae Cooper
Cooper			1812	1909			36	1			Not found during 2014 survey
Copeland	Allen	P.	1876	1941			22	19			Father; Shares stone with Annie H Copeland
Copeland	Annie	H.	1876	1943			22	18			Mother; Shares stone with Allen P Copeland
Copeland	Arthur	J.	11/23/1900	11/17/1969			5	5			Father; Vase in center with C; Forever; Shares stone with Emma S Copeland
Copeland	Billie	Ray	12/3/1940	9/14/1958			8	24			Son
Copeland	Elmis	B	3/23/1909	11/2/2002			8	19			In loving memory; praying hands; cross
Copeland	Emma	S.	4/22/1904	10/31/1992			5	6			Mother; Together; Shares stone with Arthur J Copeland
Copeland	Florence	E.	9/5/1907	4/22/19889			8	23			Mom; Shares stone with Jack O Copeland
Copeland	Jack	O.	3/1/1907	11/13/1979			8	22			Dad; Vase in center with C; Shares stone with Florence E Copeland
Coplin	Evey		12/19/1899	12/27/1904			20	1			Daughter of A.P. and S.A. Coplin; Verse at bottom
Cox	Grant		3/5/1901	7/14/1905			17	3			Son of R.A. and T.M.; Lamb
Cunningham	Clyde	E.	7/18/1897	11/8/1972			6	15			Not found during 2014 survey

Shahan Cemetery
S9, R15E, T17N, Shahan Township

Last Name	First Name	Middle	Date of Birth	Date of Death	Marriage Date	Sec	Blk/Row	Lot	Campaign	Branch	Remarks
Cunningham	Mary	L.	5/30/1901	10/20/1968			6	16			Not found during 2014 survey
D.E.B.							16	7			Field stone
Darden	Kenneth	R.	7/24/1949	8/12/1949			17	19			In His Loving Arms
Darr	John	F.	9/9/1876	11/1/1955			33	12			Father
Darr	Vina	H.	11/5/1906	9/19/1907			33	6			
Darr	William	H.	11/26/1819	9/26/1915			28	3			Gone but not forgotten
Davis	Henry	H.	10/15/1909	8/17/1910			40	1			Son of T.L. and Nellie
Dean	Roy	Garnett	8/18/1907	1/25/1969			37	10			
DeFriese	Baby						36	7			Carved Sandstone or fieldstone used as monument
Dempsey	James	W.	10/25/1896	7/21/1974			7	13			Shares stone with Viola L Dempsey
Dempsey	Viola	L.	1/17/1900	2/21/1980			7	14			Shares stone with James W Dempsey
Denton	Anna	Louicle	7/20/1930				30	2			Illegible Painted Homemade concrete marker
Denton	Betty	Jo	8/10/1928	9/15/1934							Not found during 2014 survey
Denton	Birdie		6/2/1902	8/9/1961			9	1			Shares stone with Dave Denton
Denton	Dave		7/22/1897	11/8/1970			9	2			Vase in center; Shares stone with Birdie Denton
Denton	Georgia	Ann	2/26/1966	3/4/2010			13	12			In loving memory; cross; Beloved daughter, sister and mother; vase
Denton	Ivan	Thomas	1937	1938			28	18			Baby; lamb
Denton	J.	O.	8/10/1978				30	1			
Denton	Jasper		1867	1938			27	16			Father; shares stone with Linda Denton
Denton	Linda		1879	1968			27	15			Mother; Shares stone with Jasper Denton

Shahan Cemetery
S9, R15E, T17N, Shahan Township

Last Name	First Name	Middle	Date of Birth	Date of Death	Marriage Date	Sec	Blk/Row	Lot	Campaign	Branch	Remarks
Denton	Wilson		6/7/1918	8/12/1931			27	17			Hand carved stone
Dorsey	Buck		10/24/1906	9/30/1962			36	9			
Dover	Albert			1932			22	34			Homemade concrete marker
Dover	Issac		1853	1928			22	33			Homemade concrete marker
Drake	W.	J.	1861	2/9/1933			23	1			Homemade concrete marker
Drake	Woodie	L.	11/1861	11/1946			25	12			Homemade concrete marker
Dykes	Acy	M.	8/27/1885	5/4/1966			34	1			Shares stone with Addie M Dykes
Dykes	Addie	M.	11/27/1893	2/5/1965			34	2			Together forever; Shares stone with Acy M Dykes
E.M.							28	6			Field stone
Earp	Benjamin	Franklin	4/27/1848	2/13/1908			32	1			
Edwards	Alfred	B.	1/18/1905	3/1/1976	10/18/1924		2	5			Vase in center; Shares stone with Mary E Edwards
Edwards	Mary	E.	10/8/1910	10/16/1988	10/18/1924		2	6			Shares stone with Alfred B Edwards
Erwin	Gertie		1896				8	8			Shares stone with Jed D Erwin
Erwin	J.	C.	1849	1936			24	12			Shares stone with Sarah Erwin; Homemade concrete marker
Erwin	Jed	D.	1890	1976			8	7			Vase in center; Shares stone with Gertie Erwin
Erwin	John	Raymond	5/18/1893	1/1/1975			8	5			
Erwin	Lettie	Lee	3/16/1900	12/15/1972			8	6			Not found during 2014 survey
Erwin	Sarah		1815	1933			24	13			Shares stone with J C Erwin; Homemade concrete marker
Evans	Alvin		4/10/1912	3/13/1928			22	29			Our darling
Evans	Baby						23	14			Homemade concrete marker

Shahan Cemetery
S9, R15E, T17N, Shahan Township

Last Name	First Name	Middle	Date of Birth	Date of Death	Marriage Date	Sec	Blk/Row	Lot	Campaign	Branch	Remarks
Evans	Dora	Bell	2/23/1895	6/8/1976			14	2			Mother
Evans	Eugene	C.	8/13/1920	10/17/1921			17	16			Homemade concrete marker
Evans	Harlen		2/28/1889	8/17/1957			14	1			Father
Evans	Novell	E.	9/11/1912	7/10/1916			37	2			concrete slab
Evans	Paul	Dean	4/3/1927	10/28/1978			3	5	WWII	Army	PFC; Metal veteran marker
Ezell	Albert	M.	8/22/1902	5/19/1920			17	12			Holy Bible
Ezell	Thomas			10/6/1939			17	13			OK, PVT, 439 Res. Labor BN; cross; veteran stone
F A S							24	2			Sandstone rock
Farris	Ernestine		2/5/1902	6/28/1903			17	5			Daughter of T.E. and Effa M.; Lamb; Verse at bottom
Farris	Thomas		10/16/1844	6/20/1903			17	4			As a husband devoted; As a father affectionate; As a friend ever kind & true; Holy Bible
Faulkenberry	Alfred	W.	1/4/1900	4/11/1972			9	14			I will fear no evil for Thou art with me
Faulkenberry	Bertha	C	11/19/1909	8/13/1998			9	11			Shares stone with Lee W Faulkenberry
Faulkenberry	Lee	W.	4/4/1905	1/16/1999			9	10			In God's Hands; praying hands; Shares stone with Bertha C Faulkenberry
Faulkenberry	Lois	A.	2/16/1927	2/26/2007			9	13			Together forever; praying hands; Shares stone with Walker E Faulkenberry
Faulkenberry	Walker	E.	8/3/1923	5/31/1997			9	12	WWII	Navy	Shares stone with Lois A Faulkenberry; S2; Metal veteran foot marker; vase; cross
Fetcher	Dennis		10/1/1961	2/10/1965			13	28			Lamb
Fisher	Art	E.	8/7/1882	12/25/1965			12	3			Shares stone with Hettie Fisher
Fisher	Hettie		3/29/1889	6/28/1978			12	4			Shares stone with Art E Fisher
Floyd	Shirley		1876	1957			25	17			
Foree	Eathel	Jane	1908	1931			16	12			Homemade concrete marker

Shahan Cemetery
S9, R15E, T17N, Shahan Township

Last Name	First Name	Middle	Date of Birth	Date of Death	Marriage Date	Sec	Blk/Row	Lot	Campaign	Branch	Remarks
Forester	Alma	M.	1/6/1919	3/11/1930			23	17			
Forester	Alma		1/6/1919	3/11/1930			28	19			Homemade concrete marker
Forester	Cora	B	9/2/1894	3/23/1930			23	16			Mother; Shares stone with Otis M Forester
Forester	Otis	M.	7/13/1892	11/16/1946			23	15			Father; Shares stone with Cora B Forester
Foster	Ella		1886	1961			11	7			Mother; In loving memory of
Foster	Infant		12/15/1927	12/15/1927			19	21			Infant Son of P.V. and N.D. Foster; Born on earth to bloom in heaven
Foster	Sarah	J.	3/30/1855	3/25/1926			19	20			Mother; Come Ye Blessed; Verse at bottom
Fowler	Wanda	L.	1922	1949			13	16			
Fulkerson	Al		1885	10/21/1964			35	20			
Gann	Eliza	Jane	11/17/1855	11/29/1917			25	1			Verse at bottom
Garrett	James	Evert	10/9/1905	4/8/1993			17	24			Vase in center; Shares stone with Sarah Fern Garrett
Garrett	Sarah	Fern	7/12/1910	11/1/1999			17	25			Shares stone with James Evert Garrett
Garrett	Sarah	J.	3/20/1871	3/2/1963			17	23			Shares stone with William B Garrett
Garrett	William	B.	12/29/1862	1/9/1929			17	22			Vase in center; Shares stone with Sarah J Garrett; Foot stone; Father
Gatewood	R.	L.	8/30/1880	8/24/1902			17	1			
Gill	Eva	M.	8/18/1897	11/30/1986			7	12			Share stone with Leonard T Gill
Gill	Leonard	T.	12/31/1887	12/4/1966			7	11			Vase in center with G; Shares stone with Eva M Gill
Gill	Matilda	C.	1849	1922			13	1			Mother
Givens	Leota		4/8/1930				12	12			Daughter of Harry & Ida Mae Bell; Church motif; Beloved mother of Cynthis G Lee & David Givens; vase
Glimpse	Clara		1859	1918			16	3			Shares stone with Joseph Glimpse

Shahan Cemetery
S9, R15E, T17N, Shahan Township

Last Name	First Name	Middle	Date of Birth	Date of Death	Marriage Date	Sec	Blk/Row	Lot	Campaign	Branch	Remarks
Glimpse	Joseph		1848	1911			16	2			Shares stone with Clara Glimpse
Green	Anna	Sarah	11/6/1909	9/30/1988			8	3			
Green	Leslie	Oliver	9/3/1897	8/1/1961			8	2	WWI		OK, PFC, Co K, 31 Inf; cross; veteran stone
Green	Thomas	B.	4/18/1857	12/7/1904			22	7			In my Father's house are many mansions; verse at bottom
Guthrie	Estelle	I	8/6/1913	8/2/2004			11	17			In our hearts forever; praying hands; angel; vase; Our beloved sister, mother and grandmother
Guynn	Charles	Frank	9/3/1883	6/13/1962			8	20			Father; Vase in center; Shares stone with Rosie Guynn
Guynn	E.	M.					38	7			Not found during 2014 survey
Guynn	Nona	Fern	9/8/1906	8/16/1908			37	1			Daughter of G.W. and L.E.; lamb; Stone broken and overturned; verse at bottom
Guynn	Richard		5/5/1922	2/25/1923			20	31			
Guynn	Rosie		11/6/1885	10/23/1964			8	21			Mother; Shares stone with Charles Frank Guynn
H.							16	8			
Hall	Dovie	M.	12/1/1899	11/10/1979			10	18			Shares stone with Jake W Hall
Hall	Jake	W.	6/26/1891	4/15/1964			10	17			Vases; Shares stone with Dovie M Hall
Hammett	Beulah		7/31/1912	10/23/1997			1	6			Vase in center; Shares stone with Robert J Hammett
Hammett	Robert	J.	8/7/1893	4/7/1988			1	5			Shares stone with Beulah Hammett
Hancock	Nancy	Jane	3/25/1846	2/2/1927			21	6			Gone home; praying hands; cross
Hancock	W.	O.	4/9/1895	11/3/1937			21	3			Father
Hancock	Wilma		10/31/1933	10/4/1934			21	4			
Hand	Clyde	Calvin	8/29/1918	12/12/1920			18	6			Homemade concrete marker
Hand	Delbert	D.	6/14/1908	7/9/1978			13	23			Vase in center with H; Shares stone with Laura May Hand

Shahan Cemetery
S9, R15E, T17N, Shahan Township

Last Name	First Name	Middle	Date of Birth	Date of Death	Marriage Date	Sec	Blk/Row	Lot	Campaign	Branch	Remarks
Hand	Jimmy	Dean	2/20/1948	10/1/1988			4	1			
Hand	Laura	May	5/8/1911	4/16/1995			13	24			Shares stone with Delbert D Hand
Hand	Pearl	L.	4/20/1899	2/2/1933			18	3			
Hand	R.	N.	1841	1928			18	4			Homemade concrete marker
Hand	Sarah	Katheran	8/28/1875	5/28/1945			13	22			Mother; Shares stone with William David Hand
Hand	Willard	O	10/6/1931	8/27/1997			9	19			
Hand	William	David	3/4/1872	10/21/1953			13	21			Father; Shares stone with Sarah Katheran Hand
Harrelson	Lydia	B.	1/15/1885	1/1/1914			35	1			Gone but not forgotten
Hawkins	Amanda	C.	5/10/1867	4/22/1910			17	2			Wife of T.H.; She was a kind and affectionate wife; A fond mother and friend to all
Hayes	Marie		3/4/1912	9/9/1936			25	10			Mother
Hays	B	Walter	1892	1979			14	11			Cross
Hays	Martha		1884	1962			14	10			Mother
Hendren	James	D.	5/6/1850	12/1/1930			22	15			Homemade concrete marker
Hill	Bessie	E.	10/19/1891	10/19/1973			3	19			Homemade concrete marker
Hodges	Martha	L.	11/29/1861	9/29/1905			20	8			Wife of W.G. Hodges; She died as she lived always trusting in God
Hoggatt	Amandy		3/25/1858	11/3/1910			33	2			
Holcome	F.	J.	1/22/1900	8/14/1905			15	2			Carved field stone
Hollinghead	Georgia	Hall	1/5/1930	9/16/1973			3	12			At rest; Mother; Shares stone with John A Hollinghead
Hollinghead	John	A.	6/29/1923	4/30/2007			3	13			At rest; Father; Vase in center; Shares stone with Georgia Hall Hollinghead
Hollingsworth	Greely	H.	5/5/1917	4/12/1942			28	16			He is gone to rest in heaven

Shahan Cemetery
S9, R15E, T17N, Shahan Township

Last Name	First Name	Middle	Date of Birth	Date of Death	Marriage Date	Sec	Blk/Row	Lot	Campaign	Branch	Remarks
Holt	Barbara						23	8			Homemade concrete marker
Holt	L.	N.	9/28/1858	12/9/1914			19	1			Only found unmarked field stone during 2014 survey
Hopper	Rachel	M.	12/5/1890	8/5/1909			32	2			At rest
Horn	Annie		1871	1917			24	5			Shares stone with John B Horn
Horn	Bessie	M.	1894	1959			11	5			Shares stone with Rev W P Horn
Horn	Dan	B.	8/18/1898	8/29/1965			10	11			Vases; Shares stone with Sylvia A Horn
Horn	Infant		4/21/1910	4/23/1910			24	6			Infant Son of W.P. and B.M. Horn
Horn	John	B.	1867	1962			24	4			Gone to sing in glory; Shares stone with Annie Horn
Horn	P.	M.	1835	1928			20	13			
Horn	Rev. W.	P.	1890	1966			11	4			Shares stone with Bessie M Horn
Horn	Sylvia	A.	4/18/1901	8/12/1963			10	12			Shares stone with Dan B Horn
Houser	Jane		1907	1936			29	1			Homemade concrete marker
Howell	Paul		1885	1913			26	3			Homemade concrete marker
Hudson	Everett	C.	5/16/1911	7/24/1973			15	4			Vases; Shares stone with Naomi M Hudson
Hudson	Naomi	M.	6/1/1918	7/20/1996			15	5			Shares stone with Everett C Hudson
Hudson	W.	A.	4/7/1935	7/7/1938			15	6			
Hudson	Wanda	Jean	7/5/1937	11/1937			16	6			Homemade concrete marker
Hughes	Amanda	Lou	3/6/1892	1/18/1984			9	9			Shares stone with James Henry Hughes
Hughes	James	Henry	10/29/1873	2/20/1968			9	8			Vases with H; Shares stone with Amanda Lou Hughes; Praying hands; cross
Hunt	Anna	Ida	2/16/1884	5/28/1968			12	10			Mother

Shahan Cemetery
S9, R15E, T17N, Shahan Township

Last Name	First Name	Middle	Date of Birth	Date of Death	Marriage Date	Sec	Blk/Row	Lot	Campaign	Branch	Remarks
Hunt	Marvin		1/29/1912	9/19/1933			16	14			
Jackson	Dora	M (Edwards)	8/9/1927	6/28/2010			2	9			Shares stone with Raymond E Jackson
Jackson	Raymond	E.	4/2/1924	3/29/2008			2	8			Together forever; Shares stone with Dora M (Edwards) Jackson
Jackson	Wyatt	E.	12/31/1974	1/12/1975			2	10			Lamb; cross
Jay	Baby	Boy	7/20/1963	7/20/1963			12	13			Baby Boy of Billy and Joyce Jay
Jenkins	Ben	J.	3/16/1873	12/25/1952			33	11			Father
Johnson	Arthur	L.	1914	1989			10	6			Shares stone with Grace Johnson
Johnson	Floyd	A.	1915	1991			10	8			Holy Bible
Johnson	Grace		1911	1982			10	7			Shares stone with Arthur L Johnson
Johnston	Dora						23	7			Homemade concrete marker
Johnston	Fred						23	10			Homemade concrete marker
Johnston	Kathrin						23	11			Homemade concrete marker
Johnston	Letha						23	12			Homemade concrete marker
Johnston	Melvin						23	13			Homemade concrete marker
Johnston	Robert						23	9			Homemade concrete marker
Johnston	Tom						23	6			Homemade concrete marker
Jones	Beda	Avice	1884	1956			13	36			Mother; Shares stone with Rev Fred C Jones
Jones	Etta	A.	9/18/1932		10/23/1954		11	11			Sewing machine; Shares stone with Olen G Jones
Jones	John	Lancin	12/14/1946	2/18/1968			13	39			Son of Mr. & Mrs. John K. Jones
Jones	John	W.	1849	1928			21	2			

Shahan Cemetery
S9, R15E, T17N, Shahan Township

Last Name	First Name	Middle	Date of Birth	Date of Death	Marriage Date	Sec	Blk/Row	Lot	Campaign	Branch	Remarks
Jones	John						13	18			Homemade concrete marker
Jones	Minnie	O.	6/18/1917	9/27/1994			3	7			In my Father's house are many mansions; Shares stone with Oda C Jones
Jones	Oda	C.	1/13/1909	6/7/1976			3	6			Church; Shares stone with Minnie O Jones
Jones	Olen	G.	4/23/1932	3/5/2008	10/23/1954		11	10			Guitar; Parents of Darrell, Jimmie, Yolanda; Shares stone with Etta A Jones
Jones	Rev. Fred	C.	1884	1960			13	35			Father; Shares stone with Beda Avice Jones
Justus	Hettie		8/25/1880	2/14/1966			8	4			
Kerr	John	W.	5/23/1883	12/2/1964			9	22			In loving memory; cross
Kersey	Fred		12/2/1911	10/16/1912			15	3			Son of L.C. and B.J. Kersey; Verse at bottom
Ketchum	Bonnie	Ruth	9/19/1928	2/21/1930			19	23			Homemade concrete marker
Ketchum	Ina			8/18/1905			26	2			Age 18 days; Daughter of R.A. and S.S.
Ketchum	Lolie		11/23/1901	6/2/1902			26	1			Daughter of R.A. and S.S.; Gone to bloom in the garden of heaven
Ketchum	M.	Lucille	6/14/1921	7/13/1922			19	24			Homemade concrete marker
Knight	M.		6/22/1911	4/12/1968			6	12			Homemade concrete marker
Knupp	Anthany	G.	7/30/1926	10/22/1926			20	21			Dove
Knupp	Baby		1/9/1929	1/12/1929			20	23			Dove
Knupp	Colornel	E.	8/14/1919	3/7/1939			20	24			
Knupp	Della	Mae	4/20/1918	9/16/1918			20	20			Dove
Knupp	Geneva	Naomi	3/4/1915	11/30/1924			20	22			Our loved one
Kyle	C.			11/26/1907							Not found during 2014 survey
L.I.J.							22	9			Sandstone rock marker

Shahan Cemetery
S9, R15E, T17N, Shahan Township

Last Name	First Name	Middle	Date of Birth	Date of Death	Marriage Date	Sec	Blk/Row	Lot	Campaign	Branch	Remarks
Lamberson	Oca		5/16/1910	10/23/1910			15	1			Foot stone with Baby son of Ralph and Bertha
Lambertson	Infant										Not found during 2014 survey
Lawrence	Clifton	E.	9/29/1917	7/24/1961			11	16	WWII		ARK, CPL, Co B, 62 Inf., TNG BN; Cross; Veteran stone
Lee	Annie		1841	1925			18	5			Verse at bottom
Lenard	Belle		12/24/1909	6/7/1973			4	10			Shares stone with Will Lenard
Lenard	Virginia	Lee	10/29/1941	11/15/1941			22	36			
Lenard	Will		2/3/1907	2/29/1992			4	9			Shares stone with Belle Lenard
Leonard	Dorothy	M. Welch	1/15/1935	11/25/1960			11	6			Vase
Lewis	James	F.	7/31/1851	1/10/1906			17	7			Homemade concrete marker
Lewis	Joseph	P.	1/5/1882	2/24/1976			3	17			
Lewis	Myrtle		4/25/1884	10/19/1934			29	4			Wife of J.P. Lewis; Our Mother; At rest
Luster	B.	F.	2/10/1878	3/3/1907	4/6/1900		39	1			Verse at bottom
Lynch	H.	D.	2/27/1909	7/25/1909			30	7			Son of C.L. and Oma
Maddux	Asbury		1860	1935			20	15			Not found during 2014 survey
Masterson	William	Milton	7/4/1925	7/4/1925			15	16			Son of Aaron & Rose
McCain	Addie		1881	1955			35	18			Homemade concrete marker
McClendon	Bertha	M.	7/20/1900	8/16/1974			3	18			
McClendon	Salomon	W.	1/11/1876	7/26/1925			15	17			Oddfellows emblem; Verse at bottom
McClendon	Stella	Mandy	10/5/1881	4/13/1963			10	19			Mother; Verse at the bottom
McClendon	Thelma	E.	8/16/1910	12/26/1940			21	8			Mother is not dead she is only sleeping just peacefully waiting for Jesus to come

Shahan Cemetery
S9, R15E, T17N, Shahan Township

Last Name	First Name	Middle	Date of Birth	Date of Death	Marriage Date	Sec	Blk/Row	Lot	Campaign	Branch	Remarks
McClendon			2/26/1929	2/26/1929			19	22			ADaughter born to Mr. and Mrs. George McClendon; lamb
McClung	Ella	Odessa	10/26/1909	3/1/1952			15	18			Lo, I am with you always
McFarland	Baby						27	4			Cement Cross
McFarland	Jacob	H.	1884	1949			34	4			Vases in center; Shares stone with Rachel C McFarland
McFarland	Rachel	C.	1889	1971			34	3			The Lord is my Shepherd; Shares stone with Jacob H McFarland
McKinzie	James	E.	8/18/1877	1/6/1916			19	2			Tree trunk marker with Woodmen of the World Memorial; Gone but not forgotten
McLain	Leona		2/10/1934	9/1/1944			33	8			Beloved daughter of Alice Mae (Lofton) McLain
McMillian	Effie	Victory	7/8/1911	11/1/1989			11	13			Vase in center; Shares stone with Walter Green McMillian
McMillian	Ruby	Ithel	4/14/1918	2/5/1994			11	15			
McMillian	Walter	Green	2/23/1883	1/3/1968			11	12			Shares stone with Effie Victory McMillian
McMillian	Walter	Lou	8/31/1941	11/22/1993			11	14	Vietnam	Navy	BMC; veteran stone; cross
Meyers	Irvan	T., Jr.	9/23/1942	11/18/1942			29	3			
Miller	Auda	B.	8/22/1902	7/9/1990			8	14			In loving memory of; mother of Beulah, Gary and Margaret; We loved you
Miller	Mary		1886	1916			36	6			Mother; Stone lies on the grave of Nellie Alexander
Miller	Nellie	A.	1899	1969			5	15			Shares stone with Wm Ray Miller
Miller	Wm.	Ray	1893	1975			5	14			Photo; vases; Shares stone with Nellie A Miller
Mitchell	Josie		1894	19??			27	1			Only illegible field stone found during 2014 survey
Mitchell	Lucy	York		1913			27	3			Homemade concrete marker
Mitchell	Robert		1882	1903			27	2			Only illegible field stone found during 2014 survey
Moore	Mattie	P.	1/29/1882	10/3/1933			17	17			Mother; Shares stone with Stephen S Moore

Shahan Cemetery
S9, R15E, T17N, Shahan Township

Last Name	First Name	Middle	Date of Birth	Date of Death	Marriage Date	Sec	Blk/Row	Lot	Campaign	Branch	Remarks
Moore	Stephen	S.	2/20/1866	3/23/1933			17	18			Father; Shares stone with Mattie P Moore
Morrison	Della		1896	1977			9	7			Mother; Shares stone with Harvey Morrison
Morrison	Harvey		1880	1969			9	6			Father; Vase in center with M; Shares stone with Della Morrison
Morrison	Louie	Lincoln	4/4/1916	5/4/1986			2	1			Precious Memories
Murphy	Eula	Lee	4/4/1919	10/1/1974			13	15			Shares stone with George A and Patrick J Murphy
Murphy	George	A.	9/24/1917	1/9/1969			13	13			Vases with M; Shares stone with Patrick J and Eula Lee Murphy
Murphy	Patrick	J	9/29/1953	4/15/1964			13	14			Shares stone with George A and Eula Lee Murphy
Murray	Josie		2/14/1914	3/11/1952			33	9			
Myers	Luther			1922			16	9			Homemade concrete marker
Myers	Maggie			1920			16	10			Homemade concrete marker
Myers	Tom			1936			16	11			Homemade concrete marker
N A S							24	1			Sandstone rock
Naugle	Ethel		9/11/1901	3/15/1988			8	18			Shares stone with Herbert E Naugle; at rest
Naugle	Herbert	E.	11/2/1899	10/9/1961			8	17			Shares stone with Ethel Naugle
Naugle	Vonnie	Helen	2/27/1927	3/16/1939			22	20			Daughter; I pray thee Lord my soul to keep
Neugin	Burl	D	7/4/1922	3/22/2004			12	20			Shares stone with Golda G Neugin
Neugin	Golda	G.	3/26/1918	5/18/2006			12	21			Shares stone with Burl D Neugin
Nichols	Leonard	L.	1/8/1909	1/30/1973			4	16	WWII		OK, TEC 5, Co. A, 117 Engineer BN; cross; Metal veteran marker
Noble	Alfred		6/23/1887	8/25/1975			2	3			Vase in center; Shares stone with Mandy Jane Noble
Noble	Mandy	Jane	6/10/1892	2/1/1992			2	4			Shares stone with Alfred Noble

Shahan Cemetery
S9, R15E, T17N, Shahan Township

Last Name	First Name	Middle	Date of Birth	Date of Death	Marriage Date	Sec	Blk/Row	Lot	Campaign	Branch	Remarks
Norris	Lessley		1902	1923			15	15			
Parker	Hettie		12/22/1895	3/1/1905			28	2			Daughter of G.C. and S.S. Parker; Verse at bottom
Peck	Harrison		1880	1959			12	5			Shares stone with Zetta; Vase in center
Peck	Leo		1921	1934			16	13			Homemade concrete marker
Peck	Twin	Boys	1932	1932			16	15			Angel statue at top; Homemade concrete marker
Peck	W.						12	6			Not found during 2014 survey
Peck	Zetta		1886	1986			12	7			Shares stone with Harrison Peck
Petersen	Mark	C.	2/15/1909	10/17/1977			5	7			
Peterson	Beulah	P.	11/28/1911	8/2/1973			6	6			Mother
Peterson	Grace	Z.	12/24/1878	12/6/1975			13	26			Mother; Vase in center with P; Shares stone with Henry F Peterson
Peterson	Henry	F.	4/5/1873	9/23/1948			13	25			Father; Masonic emblem; Shares stone with Grace Z Peterson; Also has foot stone
Peterson	Lynn	F.	10/1/1911	7/7/1973			11	8			Vase in center with P; Shares stone with Neva L Peterson
Peterson	Neva	L.	12/31/1915	4/14/2005			11	9			Shares stone with Lynn F Peterson
Peterson	Pauline	Ruth	10/20/1907	2/3/1961			13	27			Gone but not forgotten; vases; Also has foot stone
Pethel	Carol		3/15/1944	3/15/1944			27	14			
Phillips	Ada	L.	5/3/1897	11/15/1941			31	13			Our beloved mother; vase
Phillips	Infant		12/29/1920	1/12/1921			31	10			Infant Son of Mr. and Mrs. E.G. Phillips
Phillips	Jesse		9/21/1881	1/18/1938			31	12			
Phillips	Pheby	Jane		3/5/1910			31	6			Age 44 years; Wife of S.D.; Here lies a true Christian now at rest; lamb
Phillips	Sherman	Frank	12/20/1940	12/20/1940			35	22			Lamb

Shahan Cemetery
S9, R15E, T17N, Shahan Township

Last Name	First Name	Middle	Date of Birth	Date of Death	Marriage Date	Sec	Blk/Row	Lot	Campaign	Branch	Remarks
Phillips	Stephen	D.	8/14/1854	3/27/1933			31	11			At rest
Pilant	Ernest		1889	1909			16	4			Brother
Pilant	Ernest		1958	2000							Not found during 2014 survey
Poplin	Baby	David					23	21			Homemade concrete marker
Poplin	Beulah	M.	7/5/1890	2/7/1965			11	19			Shares stone with Tillman H Poplin
Poplin	Bobie	Lee	8/30/1932	2/2/1937			27	12			Son of Henry and Alscy; Gone but not forgotten
Poplin	George	L.	1/25/1879	1/7/1958			31	15			Beloved Father; Rest in Peace
Poplin	Henrietta		3/4/1870	8/28/1947			27	13			Mother
Poplin	Infant	E.					23	20			Not found during 2014 survey
Poplin	Tillman	H.	4/19/1893	6/18/1964			11	18			Shares stone with Beulah M Poplin
Poplin	Velda	Jo	9/30/1952	10/4/1952			31	16			
Potter	Alma	A.	1915	1916			19	4			Homemade concrete marker
Potter	Arthur		1887	1959			19	7			
Potter	Bobby	G.	1927	1928			19	15			Homemade concrete marker
Potter	Jay		1908	1953			19	9			Not found during 2014 survey
Potter	Joy	C.	1904	1958			19	8			
Potter	Joyce		1914	1914			19	5			Homemade concrete marker
Potter	Mary	Susan Chissoe	8/21/1893	11/25/1981			6	14			
Potter	Opal		1912	1983			5	2			Shares with Floyd Brown; In loving memory of; angel; Marker is in the shape of a bench
Potter	Sarah	C.	1867	1951			17	14			Mother

Shahan Cemetery
S9, R15E, T17N, Shahan Township

Last Name	First Name	Middle	Date of Birth	Date of Death	Marriage Date	Sec	Blk/Row	Lot	Campaign	Branch	Remarks
Potter	Thomas	G.	1865	1943			17	15			
Potter	William	B.	1912	1912			18	1			Homemade concrete marker
Potter	William	D.	11/12/1888	9/30/1964			10	13			Father
Potter	Wilma	Down	7/26/1930	7/23/1981			13	45			Gone but not forgotten; vases
Poynor	David, Rev.	Leroy	7/3/1820	11/12/1903			32	3			
Prater	Alvie	W.	1907	1976			2	2			
Prater	Matilda		1869	1948			27	5			
Pryer	Julie	A.	11/16/1848	10/14/1916			31	3			Wife of M.R. Pryer; Verse at bottom
Pryor	Ernest	E.	12/12/1888	8/8/1960			12	11	WWI		ARK, PFC, 19 General Hospital; cross; veteran stone
Ragan	W.	J.	1873	1931			29	2			Not found during 2014 survey
Raines	Delia		1887	1960			25	11			Grandmother
Raines	Dena	Ray	1/7/1957	1/7/1957			25	5			Shares stone with Rena Kay Raines
Raines	Dicie	B.	6/13/1904	8/29/1997			9	18			Shares stone with Roy W Raines
Raines	Erven	Ray	5/12/1912	6/16/1961			8	16	WWII		OK, PVT, Co C, 89 Inf.; cross; veteran stone
Raines	Joseph	B.	1884	1973			8	13			
Raines	Mary	J.	1/14/1875	9/3/1951			25	7			Mother; Asleep in Jesus
Raines	Newton		1850	1936			25	9			At rest
Raines	Rena	Kay	1/7/1957	1/7/1957			25	4			Shares stone with Dena Ray Raines
Raines	Roy	W.	7/27/1900	6/2/1963			9	17			Shares stone with Dicie B Raines
Raines	Sylvia		1/31/1908	9/16/1987			6	11			Wife; Shares stone with Troy N Raines

Shahan Cemetery
S9, R15E, T17N, Shahan Township

Last Name	First Name	Middle	Date of Birth	Date of Death	Marriage Date	Sec	Blk/Row	Lot	Campaign	Branch	Remarks
Raines	Troy	N.	12/18/1906	4/3/1970			6	10			Husband; Vase in center; Shares stone with Sylvia Raines
Raines	Troy	Raymond	7/23/1934	7/29/1934			25	6			Asleep in Jesus
Raines	W.	P.	4/28/1872	1/21/1935			25	8			Father; With Christ in Heaven
Ramey	Lorean	Sivia					38	4			Age 20; Illegible marker
Rankin	Gerald	Dean	7/26/1923	1/6/1996			6	3		Army	Metal veteran marker; cross
Ray	Myrtle		1901	1918			25	2			
Ray	Ovie						31	1			Sandstone or fieldstone used as monument
Reed	Elizabeth		1854	1947			19	12			Homemade concrete marker
Reed	Elmer		3/9/1900	10/11/1972			6	8			Shares stone with Mable Reed
Reed	Mable		9/15/1904	3/27/1988			6	9			Shares stone with Elmer Reed
Reed	Maggie		1899	1932			19	13			Not found during 2014 survey
Reed	Samuel	E.	1856	1927			19	11			
Reed	William	Edward	1883	1932			19	14			Homemade concrete marker
Richard	Samuel	C.	12/1/1875	1/23/1948			27	18			
Rippey	Issac	M.	10/18/1862	3/21/1912			31	2			Large white stone with Yoemen on it; Farewell dear Father sweet thy rest
Robertson	Cleta	Marie	7/23/1960	9/30/2008			1	1			
Robertson	John	William	1/9/1962	12/13/2010			1	4			Funeral home marker
Robinett	Infant		2/28/1904	2/28/1904			30	6			Infant Son of W.L. and Eva
Robins	Lacie		7/19/1903	12/13/1936			19	17			Verse at bottom
Robinson	Earl	Dean	1/4/1940	1/4/1940			35	13			Only found illegible homemade concrete marker during 2014 survey

Shahan Cemetery
S9, R15E, T17N, Shahan Township

Last Name	First Name	Middle	Date of Birth	Date of Death	Marriage Date	Sec	Blk/Row	Lot	Campaign	Branch	Remarks
Robinson	James	L.	12/31/1874	1/11/1942			22	17			At rest
Robinson	Mary	Birdie	6/13/1883	9/25/1962			13	29			
Robinson	Murl	E.	1912	1971			5	8			In loving memory
Robinson	Murl	Gene	11/7/1948	11/8/1948			35	15			Only found illegible homemade concrete marker during 2014 survey
Robinson	W.	O.	11/29/1872	3/6/1920			22	13			Age 47 yrs 3 mos 6 dys
Roller	Dollie		8/31/1894	7/11/1962			35	21			
Roller	Edgar		8/21/1898	3/1/1970			36	10			
Rosenthal	Gary	Wayne	2/28/1945	9/19/1968			4	3	Vietnam	Army	SP 4; Not found during 2014 survey
Rosenthal	Jimmy	Ray, Jr.	1/17/1949	8/18/1979			4	4	Vietnam	Marine Corps	L CPL; Not found during 2014 survey
Rundell	Alan	Lee	6/15/1957	2/14/2008			7	8			Outdoor motif
Sanders	Charles	Wade	11/2/1934	1/2/1935			13	7			Infant son of Pete and Gladys Sanders
Sanders	Chasel	J. "Pete"	3/9/1914	6/21/1995			7	9			At rest; married 62 years; vases with S; Shares stone with Gladys Marie Sanders
Sanders	Gladys	Marie	6/6/1917	7/17/1997			7	10			Shares stone with Chasel J. "Pete" Sanders
Sanders	Henry	H.	1/18/1890	11/15/1974			4	12			Vase in center with S; Shares stone with Rosie Lee Sanders
Sanders	Michael	Dwain	8/19/1961	4/10/1981			7	5			Beloved son, brother and friend
Sanders	Rosie	Lee	12/2/1892	6/11/1983			4	13			Shares stone with Henry H Sanders
Schauffler	Eva	Olive	3/31/1894	5/28/1973			12	15			Mother; There will be no parting in heaven; Shares stone with Millard F Schauffler
Schauffler	Millard	F.	5/11/1892	1/2/1960			12	14			Father; There will be no parting in heaven; Shares stone with Eva Olive Schauffler
Scroggins	Altha	Maxine	9/10/1931	6/26/1944			21	11			Our Daughter
Shahan	Anna	Mae	1897	1977			12	19			Shares stone with James E Shahan

Shahan Cemetery
S9, R15E, T17N, Shahan Township

Last Name	First Name	Middle	Date of Birth	Date of Death	Marriage Date	Sec	Blk/Row	Lot	Campaign	Branch	Remarks
Shahan	Betty	Lee	4/13/1926	7/10/1979			3	4			In God We Trust; Shares stone with James Harold Shahan
Shahan	Claude		1897	1950			13	44			Shares stone with Ova E Shahan
Shahan	Dale	Lee	9/16/1969	10/6/1971			3	2			Homemade concrete marker
Shahan	Dora	Eller	11/14/1876	3/19/1964			13	42			
Shahan	Fanny	E	1876	1948			13	41			Shares stone with James B Shahan
Shahan	James	B.	1870	1950			13	40			Shares stone with Fanny E Shahan
Shahan	James	E.	1894	1970			12	18			Shares stone with Anna Mae Shahan
Shahan	James	Harold	9/10/1919	4/8/1999			3	3	WWII	Navy	Shares stone with Betty Lee Shahan; Metal veteran marker on grave behind head stone; S1; cross
Shahan	Louisa		6/25/1844	1/28/1905			26	4			Wife of J A Shahan
Shahan	Ova	E.	1901	1993			13	43			Shares stone with Claude Shahan
Shahan	Roy		10/21/1889	10/26/1902			28	1			Son of J.F. and M.C. Shahan; Verse at bottom
Shults	W.	H.	6/23/1854	10/4/1906			38	9			Woodmen of the World Memorial; verse at bottom
SIG's baby	Infant		2/8/1941	3/1/1941			20	25			Dove
Sivia	C.	L.					38	3			Hand painted marker
Sivia	D.	P.					38	2			Hand painted marker
Sivia	E.	R.					38	1			Hand painted marker
Sivia							38	6			
Slape	S.	C.					15	11			Carved field stone
Sloan	Denise	Irene	4/23/1958	10/8/2000			28	14			Our loving mother; vase
Sly	Charles	Henry	3/12/1887	3/12/1959			28	7			Shares stone with Sadie May Sly

Shahan Cemetery
S9, R15E, T17N, Shahan Township

Last Name	First Name	Middle	Date of Birth	Date of Death	Marriage Date	Sec	Blk/Row	Lot	Campaign	Branch	Remarks
Sly	Sadie	May	11/28/1894	2/10/1939			28	8			Shares stone with Charles Henry Sly
Smith	Homer	O.	3/4/1900	9/21/1935			33	15			Shares stone with Myrtle G Smith; Also has foot stone
Smith	Myrtle	G.	1/9/1900	5/11/1981			33	14			Vase in center with S; Shares stone with Homer O Smith
Smith	Tressie	May	3/4/1930	12/14/1932			21	1			Field stone
Snelson	Emma	Irene	3/25/1924	1/13/1977			3	15			Shares stone with Georgia D Snelson
Snelson	Georgia	D	10/25/1940	11/20/2002			3	14			Vase in center; Shares stone with Emma Irene Snelson
Snelson	Ricky	Darrell, Jr.	4/13/1974	9/21/1985			3	16			"Going Home"; Vase with RS; The sweetest thing I've ever known is loving you
Snider	Bell						19	18			Homemade concrete marker
Stapp	J.	W.	11/6/1871	9/18/1908			31	4			The sweet remembrance of the just shall flourish when they sleep in dust
Stephens	M.	A.	11/15/1848	4/27/1909			19	6			Carved field stone
Sturgeon	A.	W.	1872	1948			21	12			Homemade concrete marker
Summers	Archie	V	9/24/1907	6/25/1991			12	16			Beloved dad and husband; vase in center; Shares stone with Mary Katherine Summers
Summers	Grace	E.	8/4/1879	5/30/1957			13	37			Shares stone with James W Summers
Summers	James	W.	3/7/1870	12/6/1963			13	38			Shares stone with Grace E Summers
Summers	Mary	Katherine	5/4/1915	7/29/1980			12	17			Beloved wife and mother; Shares stone with Archie V Summers
Swarer	Bradley	Stephen	2/26/1966	2/26/1966			13	11			
Swarer	Chanie		1891	1932			25	3			Mother; Vase
Swarer	Dewey	E.	12/12/1911	8/16/2008			6	17			Vase in center with S; Shares stone with Rosa Ann Swarer
Swarer	Geneva	Bates	3/19/1910	5/15/1945			13	9			Family head stone, information is on foot stone; Head stone shared with Wesley Eugene Swarer
Swarer	Grace		1885	1923			13	4			Shares stone with Jacob Swarer

Shahan Cemetery
S9, R15E, T17N, Shahan Township

Last Name	First Name	Middle	Date of Birth	Date of Death	Marriage Date	Sec	Blk/Row	Lot	Campaign	Branch	Remarks
Swarer	Howard	Don	12/18/1931	10/9/1973			13	8	Korea	Army	Oklahoma, PFC; cross; Metal veteran marker
Swarer	Jacob		1880	1942			13	5			Shares stone with Grace Swarer
Swarer	Lester	E.	6/17/1919	1/12/1971			7	7	WWII		Shares stone with Mary B Swarer; Oklahoma, TEC 4, Btry D, 118 Coast Arty; Veteran foot stone has b. year 1918; cross
Swarer	Mary	B.	3/28/1926	12/5/2001			7	6			Parents of Linda, Larry & Randy; Vase in center; Shares stone with Lester E Swarer
Swarer	Rosa	Ann	11/29/1914	10/28/1936			6	18			Shares stone with Dewey E Swarer
Swarer	Shiela	L.	1/3/1968	1/7/1969			6	19			Daughter; Photo
Swarer	Wesley	Eugene	9/5/1905	11/27/1956			13	10			Family head stone, information is on foot stone; Head stone shared with Geneva Bates Swarer
Swearer	Arimada	Fay					13	3			Homemade concrete marker
Swearer	Chester						13	2			Homemade concrete marker
Swearer	Ruby	Roberta					13	6			Homemade concrete marker
Tattershall	Gladys	S.	12/16/1902	3/4/1998			4	18			
Tattershall	Willard	H.	1895	1973			4	17			
Tatum	I.	R.					40	2	Civil War	Union Army	Co. D, 24 Mo. Inf
Thompson	John	Charles	10/8/1929	9/15/2008			6	2	WWII	Marine Corps	PFC; Forever in our hearts; Metal veteran marker
Thompson	Lois	F.	11/28/1930	5/24/1967			6	1			Mother and Wife
Thompson	Mettie	W.	1869	1954			13	32			
Thompson	Prudie		2/13/1902	7/29/1936			13	17			
Timms	Jim		5/8/1908	1/19/1930			22	28			Painted concrete marker - illegible during 2014 survey
Tincher	James		8/3/1893	11/5/1974			9	16			Shares stone with Martha E Tincher
Tincher	Martha	E.	6/19/1893	10/7/1964			9	15			Shares stone with James Tincher

Shahan Cemetery
S9, R15E, T17N, Shahan Township

Last Name	First Name	Middle	Date of Birth	Date of Death	Marriage Date	Sec	Blk/Row	Lot	Campaign	Branch	Remarks
Tooms	Beatrice	Potter	5/12/1899	2/8/1975			10	14			
Townsley	Henry	Burl	1904	1932			27	10			Veteran emblem; Homemade concrete marker
Townsley	J.	H.	9/2/1874	10/1/1946			27	7			Gone but not forgotten; Shares stone with Sallie Townsley
Townsley	Sallie		11/24/1881	7/3/1963			27	8			Vases; Shares stone with J H Townsley
Turner	Cecil	E	8/4/1902	4/14/1958			14	9			Father; Shares stone with Maggie M Turner and Herman Turner
Turner	Herman		6/13/1939	2/17/1959			14	8			Brother; Shares stone with Maggie M Turner and Cecil E Turner
Turner	Maggie	M.	3/21/1914	1/8/1994			14	7			Mother; Shares stone with Herman Turner and Cecil E Turner
Unknown	Infant		11/22/1928	11/22/1928			15	7			Illegible marker
Unknown							3	1			Metal Pipe; Funeral Home Marker
Unknown							16	1			Field stone
Unknown							17	6			Field stone
Unknown							17	8			Field stone
Unknown							17	9			Field stone
Unknown							17	11			Marble marker
Unknown							19	16			Rock
Unknown							19	19			Field stone
Unknown							20	2			Field stone
Unknown							20	3			Field stone
Unknown							20	4			Field stone
Unknown							20	5			Field stone

Shahan Cemetery
S9, R15E, T17N, Shahan Township

Last Name	First Name	Middle	Date of Birth	Date of Death	Marriage Date	Sec	Blk/Row	Lot	Campaign	Branch	Remarks
Unknown							20	6			Field stone
Unknown							20	7			Field stone
Unknown							20	10			Field stone
Unknown							20	11			Field stone
Unknown							20	12			Field stone
Unknown							20	26			Masonry cap stone
Unknown							20	27			Masonry cap stone
Unknown							20	28			Masonry cap stone
Unknown							20	29			Masonry cap stone
Unknown							20	30			Bedstead
Unknown							21	5			Masonry cap stone
Unknown							21	13			Concrete block
Unknown							22	2			Concrete marker
Unknown							22	3			Concrete marker
Unknown							22	6			Field stone
Unknown							22	8			Field stone
Unknown							22	12			Field stone
Unknown							22	22			Field stone
Unknown							22	23			Field stone
Unknown							24	3			Field stone

Shahan Cemetery
S9, R15E, T17N, Shahan Township

Last Name	First Name	Middle	Date of Birth	Date of Death	Marriage Date	Sec	Blk/Row	Lot	Campaign	Branch	Remarks
Unknown							24	7			Field stone
Unknown							24	8			Field stone
Unknown							25	14			Field stone
Unknown							28	17			
Unknown							30	4			Illegible Field stone
Unknown							30	5			Illegible Field stone
Unknown							31	5			Field stone
Unknown							31	8			Field stone
Unknown							33	1			Field stone
Unknown							33	5			Field stone
Unknown							33	7			
Unknown							33	10			Baby bed frame
Unknown							35	2			Base only found during 2014 survey
Unknown							35	3			Field stone
Unknown							35	6			Field stone
Unknown							35	7			Field stone
Unknown							36	2			Field stone
Unknown							36	3			Field stone
Unknown							36	4			Field stone
Unknown							37	3			Field stone

Shahan Cemetery
S9, R15E, T17N, Shahan Township

Last Name	First Name	Middle	Date of Birth	Date of Death	Marriage Date	Sec	Blk/Row	Lot	Campaign	Branch	Remarks
Unknown							37	4			Field stone
Unknown							38	10			Illegible carved field stone
Unknown							38	11			Field stone
Unknown							41	3			Field stone
Vaughn	Nova	M.	3/13/1909	4/24/1970			10	4			
Victory	Coretha		9/28/1922	4/13/1930			25	16			
Victory	Donald	E.	8/21/1934	5/26/1977			1	7			Together forever; Shares stone with Sandra C Victory
Victory	Infant		4/27/1979	4/27/1979			4	15			Daughter of Joy Victory; vase
Victory	Inis		1905	1995			6	21			Mother; Vase in center with V; Shares stone with roy L Victory
Victory	John		11/10/1889	1/10/1967			7	15			Carved field stone
Victory	Lew	Hilman	3/6/1887	3/9/1980			5	16			Vase in center with V; Shares stone with Rebekah Ann Victory
Victory	Rebekah	Ann	6/19/1896	2/28/1970			5	17			Shares stone with Lew Hilman Victory
Victory	Roy	L.	1901	1969			6	20			Father; Shares stone with Inis Victory
Victory	Sandra	C.	1/16/1944				1	8			Vases; Shares stone with Donald E Victory
W.H.							19	3			Field stone
Wade	Catherine		1/4/1835	8/18/1920			15	9			Mother; Aged 85 years 8 mos 14 days; Shares stone with Richard Wade
Wade	Chas.	B.	1863	1927			15	10			Son
Wade	Richard		9/4/1834	10/17/1919			15	8			Father; Aged 85 years 1 mo 13 days; Shares stone with Catherine Wade
Walker	Homer		12/4/1919	11/20/1934			16	5			
Wallace	Mary	E.	3/12/1861	3/27/1937			27	11			

Shahan Cemetery
S9, R15E, T17N, Shahan Township

Last Name	First Name	Middle	Date of Birth	Date of Death	Marriage Date	Sec	Blk/Row	Lot	Campaign	Branch	Remarks
Wasson	Ameul		3/12/1913	3/12/1913			35	10			
Wasson	Lawrence	C.	9/28/1915	12/14/1917			30	3			
Wasson	Myrthia		12/11/1916	8/22/1918			35	11			
Watkins	Emma	L.	10/22/1910	5/22/1997			3	11			Wife - Mother; Church; Bible; Shares stone with Finis W Watkins
Watkins	Finis	W.	8/15/1906	11/7/1974			3	10			Husband - Father; Shares stone with Emma L Watkins
Watkins	Henry	Logan									Not found during 2014 survey
Watkins	Jim		1842	1931			23	4			Hand painted marble marker
Watkins	Susie										Not found during 2014 survey
Watson	Fred	Dewey	6/5/1918	8/10/1973			4	14	WWII	Army	Georgia Cpl ; cross; Metal veteran marker
Watson	Larry	Dwain	1/14/1951	6/23/1996			1	9			He was found faithful in the eyes of the Lord
Wells	J.	C.	11/25/1837	11/27/1907			28	4			Lamb; Age 70 yrs 2 dys
Whitaker	Emmy	Addine	10/14/1886	5/13/1970			5	4			Mother; Forever; Shares stone with George Enoch Whitaker
Whitaker	George	Enoch	1/19/1882	4/3/1970			5	3			Father; Together; Shares stone with Emmy Addine Whitaker
Whitaker	Henry	V.	2/23/1909	8/22/1973			4	11			Brother
Wicker	Albert	R.	1908	1952			22	31			Beloved Father
Wicker	Barbara	J.	9/11/1938	10/15/1938			25	15			
Wicker	Bobby	S.	9/15/1934	1/19/1935			23	19			Son
Wicker	Caroline	S.	2/10/1931	12/11/1937			23	18			Daughter
Wicker	Charline		2/10/1931	12/11/1937							Not found during 2014 survey
Wicker	Ida	Bell	7/17/1881	7/23/1958			22	30			Beloved Mother

Shahan Cemetery
S9, R15E, T17N, Shahan Township

Last Name	First Name	Middle	Date of Birth	Date of Death	Marriage Date	Sec	Blk/Row	Lot	Campaign	Branch	Remarks
Wicker	James	Newton	1/13/1876	4/17/1933			22	35			Beloved Father
Willhoite	Grace	Erma	11/4/1899	8/21/1957			13	31			
Willhoite	Irvin	E.	3/7/1900	9/29/1971			13	30			
Willhoite	Karen	J.	10/17/1967	10/19/1967			6	7			
Williams	Blanche		11/27/1892	9/9/1921			31	9			Wife of Marshall; Stone overturned
Williams	Bud		1902	1972			10	22			
Williams	Infant		6/25/1913	6/25/1913			35	4			Son of R.A. and B.B.; Budded on earth to bloom in heaven
Williams	Mrs. Verna		5/5/1911	6/7/1962			10	23			Homemade concrete marker
Wilson	Robert	Henry	8/7/1904	1/7/1906			17	10			Lamb; Verse at bottom
Woodward	Katelyn	Marie	1/26/1966	1/26/1966			7	4			Teddy Bear
Woodward	Norma	Lea	1954	1954			28	11			Vase
Wright	Ida	B.	10/9/1895	3/24/1973			9	20			Mom; Shares stone with John A Wright
Wright	John	A.	1/16/1896	2/12/1964			9	21			Dad; Vase in center; Shares stone with Ida B Wright