

# The Crossing at 91st Phase II

A PART OF THE NE/4 OF THE SW/4 OF SECTION 14, TOWNSHIP 18 NORTH, RANGE 15 EAST  
AN ADDITION TO WAGONER COUNTY, OKLAHOMA

**SURVEYOR:**  
Benchmark Surveying &  
Land Services, Inc.  
P.O. Box 1078  
Owasso, Oklahoma 74055  
Phone: (918) 274-9081

**OWNER/DEVELOPER**  
Rausch Coleman  
Seventy-Sixth Place, LLC  
10159 East 11th Street  
Tulsa, Oklahoma 74128  
Phone: (918) 833-5005

**ENGINEER**  
Independent Design  
Consultants, LLC  
1520 West Dogwood Street  
Rogers, Arkansas 72756  
Phone: (479) 621-7837



Scale: 1"=100'



- ACC ACCESS PERMITTED
- B/L BUILDING SETBACK LINE
- D/E DRAINAGE EASEMENT
- LNA LIMITS OF NO ACCESS
- P/E PEDESTRIAN EASEMENT
- R/W RIGHT-OF-WAY
- U/E UTILITY EASEMENT
- FLOOD ZONE "AE" (100-YEAR)  
AS SCALED FROM FEMA FIRM

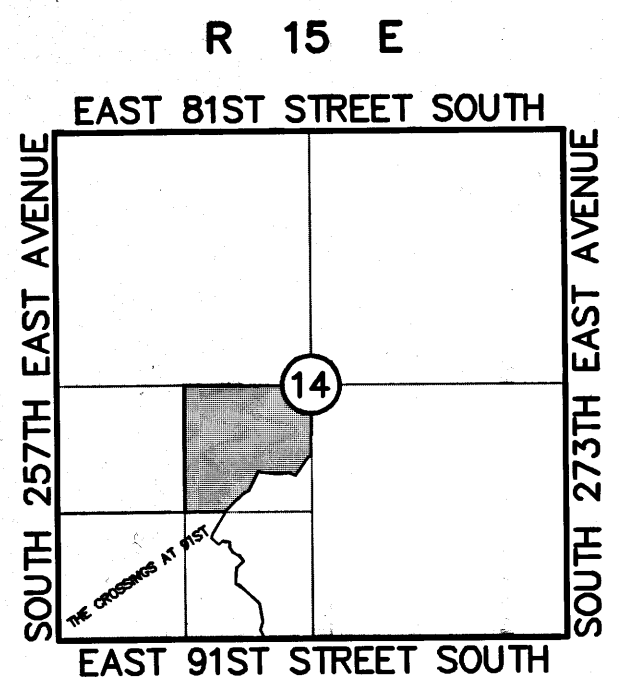

**Location Map**  
SCALE: 1"=2000'

SUBDIVISION CONTAINS 120 LOTS IN 3 BLOCKS  
AND 5 RESERVE AREAS  
TOTAL AREA 32.92 ACRES  
THE BEARING BASE FOR THIS PLAT IS STATE PLANE GRID BEARINGS

**Curve Information**

CURVE #	LENGTH	DELTA	RADIUS	CHORD	BEARING
C1	39.24'	89°56'05"	25.00'	35.34'	S 46°15'41" E
C2	39.30'	90°03'55"	25.00'	35.38'	S 43°44'19" W
C3	53.53'	63°53'46"	48.00'	50.80'	S 56°49'24" W
C4	130.42'	276°45'22"	27.00'	35.87'	S 16°44'48" E
C5	27.53'	32°51'36"	48.00'	27.15'	N 74°7'55" W
C6	78.59'	90°03'22"	50.00'	70.75'	S 43°44'36" W
C7	75.90'	43°29'16"	100.00'	74.09'	S 20°27'33" W
C8	81.18'	46°30'44"	100.00'	78.97'	S 65°27'33" W

**Addresses**

- BLOCK ONE**
- 1 8956 S 261st E AVE
  - 2 8840 S 261st E AVE
  - 3 8826 S 261st E AVE
  - 4 8824 S 261st E AVE
  - 5 8798 S 261st E AVE
  - 6 8786 S 261st E AVE
  - 7 8770 S 261st E AVE
  - 8 8756 S 261st E AVE
  - 9 8742 S 261st E AVE
  - 10 8726 S 261st E AVE
  - 11 8710 S 261st E AVE
  - 12 8698 S 261st E AVE
  - 13 8664 S 261st E AVE
  - 14 8670 S 261st E AVE
  - 15 8658 S 261st E AVE
  - 16 8644 S 261st E AVE
  - 17 8628 S 261st E AVE
  - 18 8614 S 261st E AVE
- BLOCK TWO**
- 1 26071 E 86th St S
  - 2 26091 E 86th St S
  - 3 26109 E 86th St S
  - 4 26131 E 86th St S
  - 5 26149 E 86th St S
  - 6 26169 E 86th St S
  - 7 26189 E 86th St S
  - 8 26209 E 86th St S
  - 9 26227 E 86th St S
  - 10 26247 E 86th St S
  - 11 26265 E 86th St S
  - 12 26285 E 86th St S
  - 13 26305 E 86th St S
  - 14 26325 E 86th St S
  - 15 26345 E 86th St S
  - 16 26363 E 86th St S
  - 17 26381 E 86th St S
  - 18 26395 E 86th St S
  - 19 8601 S 264th E Ave
  - 20 8611 S 264th E Ave
  - 21 8621 S 264th E Ave
  - 22 8633 S 264th E Ave
  - 23 8645 S 264th E Ave
  - 24 8661 S 264th E Ave
  - 25 8673 S 264th E Ave
  - 26 8685 S 264th E Ave
  - 27 8695 S 264th E Ave
  - 28 26396 E 87th St S
  - 29 26386 E 87th St S
  - 30 26366 E 87th St S
  - 31 26331 E 87th St S
  - 32 26335 E 87th St S
  - 33 26345 E 87th St S
  - 34 26359 E 87th St S
  - 35 26381 E 87th St S
  - 36 26380 E 86th Pl S
  - 37 26356 E 86th Pl S
  - 38 26336 E 86th Pl S
  - 39 26316 E 86th Pl S
  - 40 26296 E 86th Pl S
  - 41 26274 E 86th Pl S
  - 42 26250 E 86th Pl S
  - 43 8659 S 262nd E Ave
  - 44 8671 S 262nd E Ave
  - 45 8683 S 262nd E Ave
  - 46 8693 S 262nd E Ave
  - 47 8707 S 262nd E Ave
  - 48 8717 S 262nd E Ave
  - 49 8729 S 262nd E Ave
  - 50 8735 S 262nd E Ave
  - 51 8747 S 262nd E Ave
  - 52 8753 S 262nd E Ave
  - 53 8763 S 262nd E Ave
  - 54 8773 S 262nd E Ave
  - 55 8781 S 262nd E Ave
  - 56 8791 S 262nd E Ave
- BLOCK THREE**
- 1 8819 S 261st E Ave
  - 2 8803 S 261st E Ave
  - 3 8787 S 261st E Ave
  - 4 8771 S 261st E Ave
  - 5 8757 S 261st E Ave
  - 6 8745 S 261st E Ave
  - 7 8727 S 261st E Ave
  - 8 8711 S 261st E Ave
  - 9 8697 S 261st E Ave
  - 10 8683 S 261st E Ave
  - 11 8669 S 261st E Ave
  - 12 8655 S 261st E Ave
  - 13 8643 S 261st E Ave
  - 14 8629 S 261st E Ave
  - 15 8615 S 261st E Ave
  - 16 26154 E 86th St S
  - 17 26170 E 86th St S
  - 18 26196 E 86th St S
  - 19 26216 E 86th St S
  - 20 26238 E 86th St S
  - 21 26260 E 86th St S
  - 22 26282 E 86th St S
  - 23 26302 E 86th St S
  - 24 26322 E 86th St S
  - 25 26340 E 86th St S
  - 26 26360 E 86th St S
  - 27 26382 E 86th St S
  - 28 26379 E 86th Pl S
  - 29 26357 E 86th Pl S
  - 30 26337 E 86th Pl S
  - 31 26317 E 86th Pl S
  - 32 26295 E 86th Pl S
  - 33 26273 E 86th Pl S
  - 34 26251 E 86th Pl S
  - 35 26229 E 86th Pl S
  - 36 26211 E 86th Pl S
  - 37 26203 E 86th Pl S
  - 38 8654 S 262nd E Ave
  - 39 8662 S 262nd E Ave
  - 40 8672 S 262nd E Ave
  - 41 8682 S 262nd E Ave
  - 42 8694 S 262nd E Ave
  - 43 8708 S 262nd E Ave
  - 44 8718 S 262nd E Ave
  - 45 8728 S 262nd E Ave
  - 46 8752 S 262nd E Ave

**Note:**  
Addresses shown on this plot are accurate at the time the plat was filed. Addresses are subject to change and should not be relied upon in place of the legal description.



**Legal Description**

A TRACT OF LAND THAT IS PART OF THE NORTHEAST QUARTER (NE/4) OF THE SOUTHWEST QUARTER (SW/4) OF SECTION 14, TOWNSHIP 18 NORTH, RANGE 15 EAST OF THE I.B. & M., WAGONER COUNTY, OKLAHOMA, MORE PARTICULARLY DESCRIBED AS FOLLOWS:

COMMENCING FROM THE SOUTHWEST CORNER OF SAID SW/4; THENCE N 116°32' W A DISTANCE OF 1317.67 FEET ALONG THE WEST LINE OF SAID SECTION TO THE NORTHWEST CORNER OF THE SW/4 OF SAID SW/4; THENCE N 88°44'59" E ALONG THE NORTH LINE OF SAID SW/4 OF SAID SW/4 A DISTANCE OF 40.00 FEET TO THE NORTHWEST CORNER OF LOT 8, BLOCK 1 OF THE CROSSING AT 91ST; AN ADDITION TO WAGONER COUNTY, ACCORDING TO THE RECORDED PLAT THEREOF; THENCE N 88°44'59" E A DISTANCE OF 1278.83 FEET TO THE SOUTHWEST CORNER OF THE NE/4 OF THE SW/4, BEING THE POINT OF BEGINNING; THENCE N 01°17'05" W ALONG THE WEST LINE OF THE NE/4 OF THE SW/4 OF SAID SECTION 14 A DISTANCE OF 1317.17 FEET TO NORTHWEST CORNER OF THE NE/4 OF THE SW/4 OF SAID SECTION 14; THENCE N 88°46'17" E ALONG THE NORTH LINE OF THE SW/4 OF SAID SECTION 14 A DISTANCE OF 1318.62 FEET TO NORTHEAST CORNER OF THE SW/4 OF SAID SECTION 14; THENCE S 01°17'38" E ALONG THE EAST LINE OF THE NE/4 OF THE SW/4 OF SAID SECTION 14 A DISTANCE OF 744.63 FEET; THENCE S 88°42'15" W A DISTANCE OF 31.28 FEET; THENCE S 32°25'11" W OF SAID SECTION 14 A DISTANCE OF 174.37 FEET; THENCE S 84°27'56" W A DISTANCE OF 232.22 FEET; THENCE N 66°07'41" W A DISTANCE OF 73.75 FEET; THENCE S 82°25'11" W A DISTANCE OF 214.62 FEET; THENCE N 84°25'01" W A DISTANCE OF 174.37 FEET; THENCE S 45°11'21" W A DISTANCE OF 228.67 FEET; THENCE S 30°25'06" W A DISTANCE OF 27.35 FEET TO THE NORTHEAST CORNER OF SAID THE CROSSING AT 91ST; THENCE S 88°42'55" W ALONG THE NORTH LINE OF SAID THE CROSSING AT 91ST A DISTANCE OF 264.26 FEET; THENCE S 82°41'51" W A DISTANCE OF 50.28 FEET; THENCE S 88°44'59" W A DISTANCE OF 110.00 FEET TO THE POINT OF BEGINNING.

Certified True Copy  
CAROLYN KUSLER, COUNTY CLERK  
Wagoner County, Okla.  
Dawn M. Stewart, DEPUTY