

**CHISSOE ADDITION
TO
COWETA, OKLAHOMA**
SCALE 1"=100'

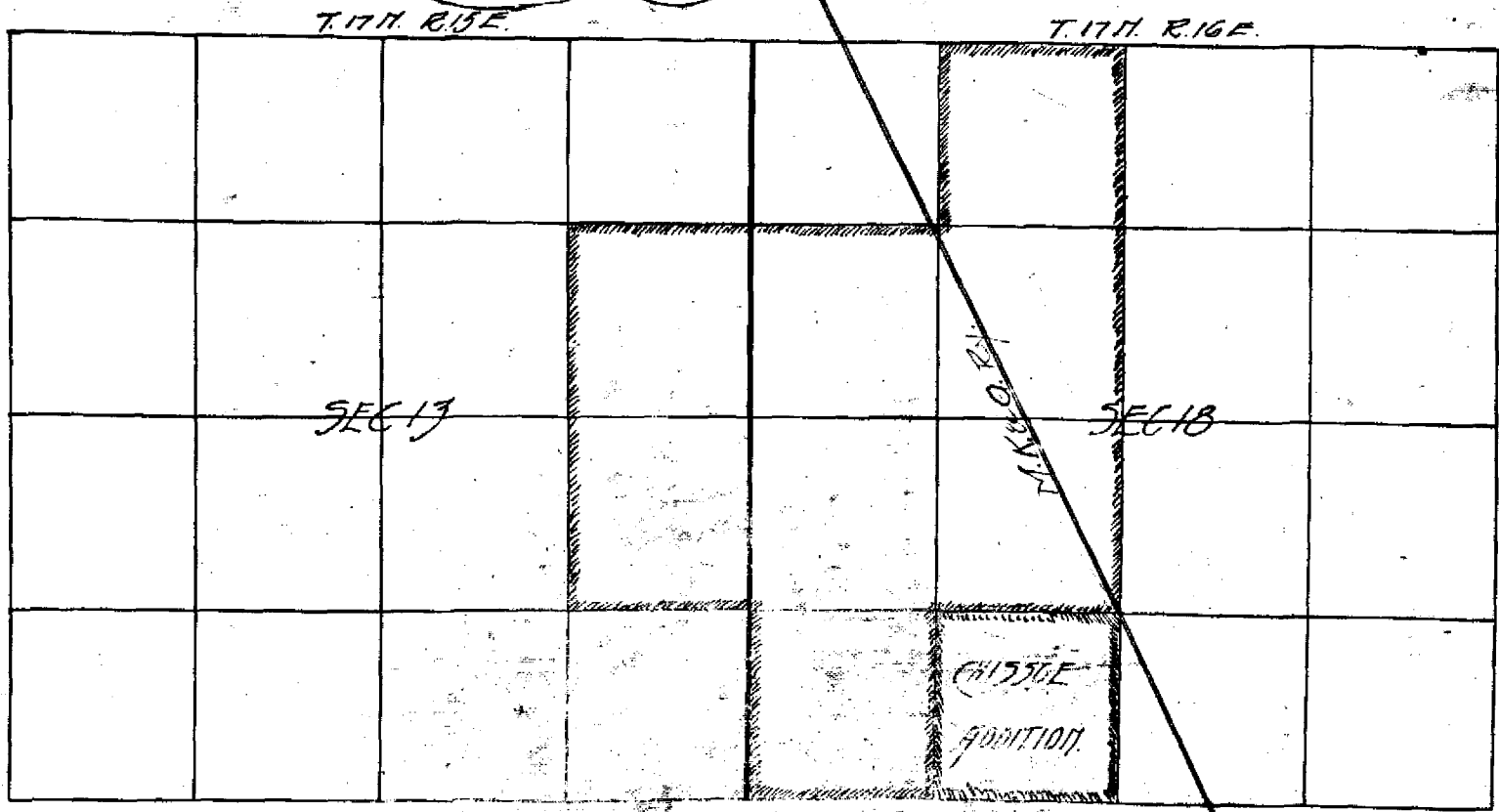

Wagoner, Okla.
I, H. H. Hellen, hereby certify that the accompanying plot is a true and correct plot of the CHISSOE ADDITION to COWETA, OKLA., as surveyed by me, on the 12th day of Dec. 1913.

STATE OF OKLAHOMA }
COUNTY OF WAGONER }

H. H. Hellen
Civil Engineer.

I, H. H. Hellen, do hereby certify that I am a Surveyor and Civil Engineer, that I have carefully and accurately surveyed, staked and plotted the CHISSOE ADDITION, the same being an Addition to the City of Coweta, Oklahoma, embracing the following described land, to wit:
The Southeast Quarter of the South west Quarter of Section Eighteen (18), Township Seventeen (17) North, Range Sixteen (16) East, into Lots, Blocks, Streets and Alleys, and that this is a true and correct plat thereof. Witness my hand this 9th day of April, 1919.

H. H. Hellen
C.E.

STATE OF OKLAHOMA }
COUNTY OF WAGONER }

Before me, the undersigned Notary Public, in and for said County and State, on this 9th day of April 1919, personally appeared H. H. Hellen, to me known to be the identical person who executed the within and foregoing instrument, and acknowledged to me that he executed the same as his free and voluntary act and deed for the uses and purposes therein set forth.

My Commission expires
August 5, 1920

Andrew B. ...
Notary Public

