

NOTE:
 INTEGRATED ARCHITECTURE WAS NOT INVOLVED PRIOR TO OR DURING THE REMODEL OF THE FOGGY BOTTOM KITCHEN RESTAURANT. DRAWINGS AND DOCUMENTS CONSIST OF INFORMATION PROVIDED TO INTEGRATED ARCHITECTURE BY THE STATE OF OKLAHOMA, SWADLEY'S WORLD FAMOUS BAR-B-Q AND ON-SITE VERIFICATION OF CURRENT SITE CONDITIONS ALSO CONTRIBUTED TO INFORMATION SUBMITTED.

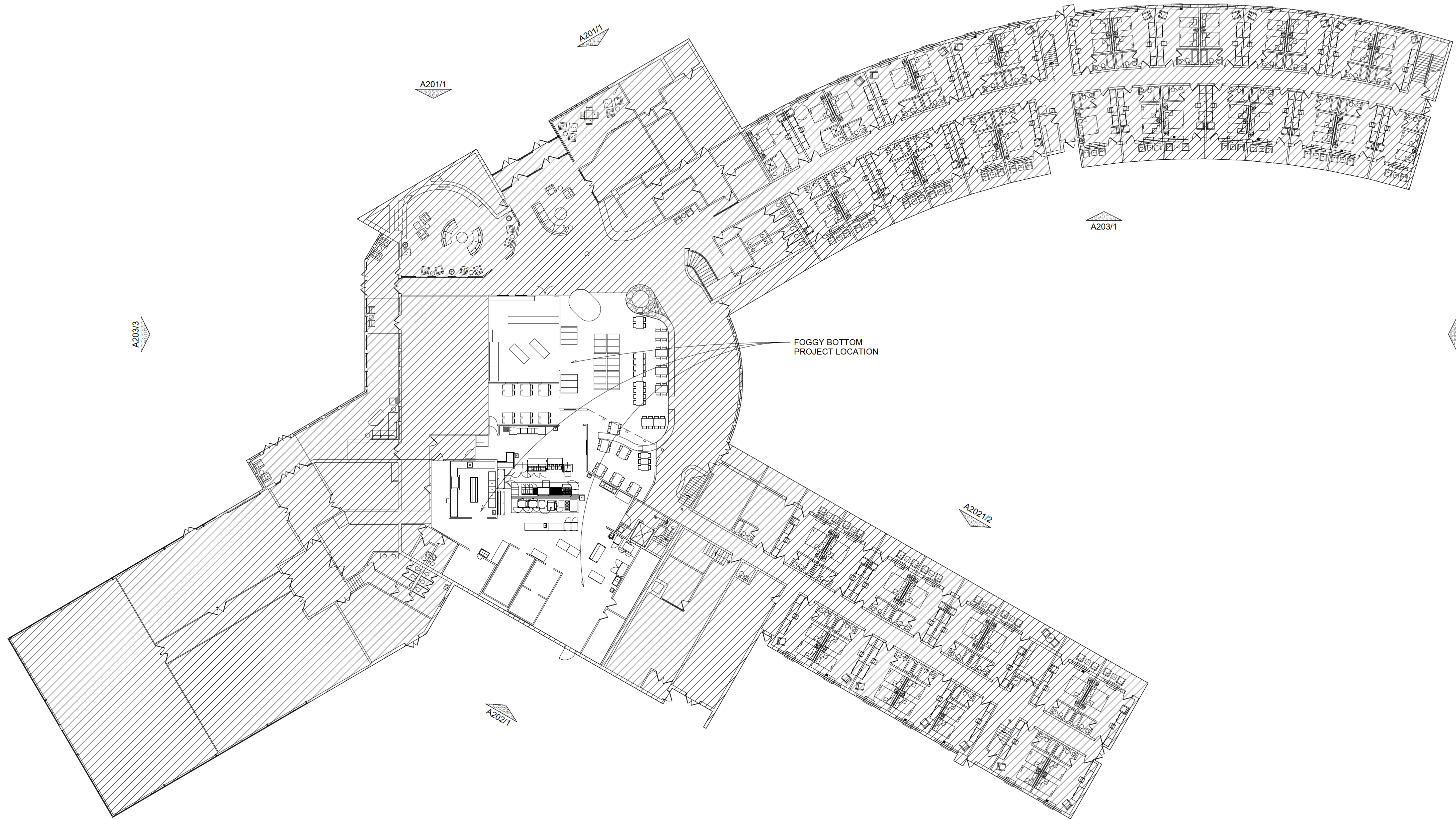

INTEGRATED ARCHITECTURE
 www.integratedarc.com
 P.O. Box 7808 Edmond, OK 73078 (405) 255-4243
 CIVIL ENGINEERING

STRUCTURAL ENGINEERING
 MEP ENGINEERING

SEQUOYAH STATE PARK
 17131 PARK 10
 HULBERT, OK 74441

CLIENT
 SWADLEY'S WORLD FAMOUS
 BAR-B-Q
 PROJECT # 21028
 ISSUED BY DRAWN BY / CHECKED BY
 Author Checker

REVISIONS

No.	Description	Date

SEAL 09/10/21
 STATE OF OKLAHOMA
 MARK D. GANDY
 3254
 ISSUED FOR PERMIT DRAWINGS

SHEET NAME
 OVERALL FLOOR PLAN

SHEET NUMBER
 A101

1 OVERALL FLOOR PLAN
 1/16" = 1'-0"

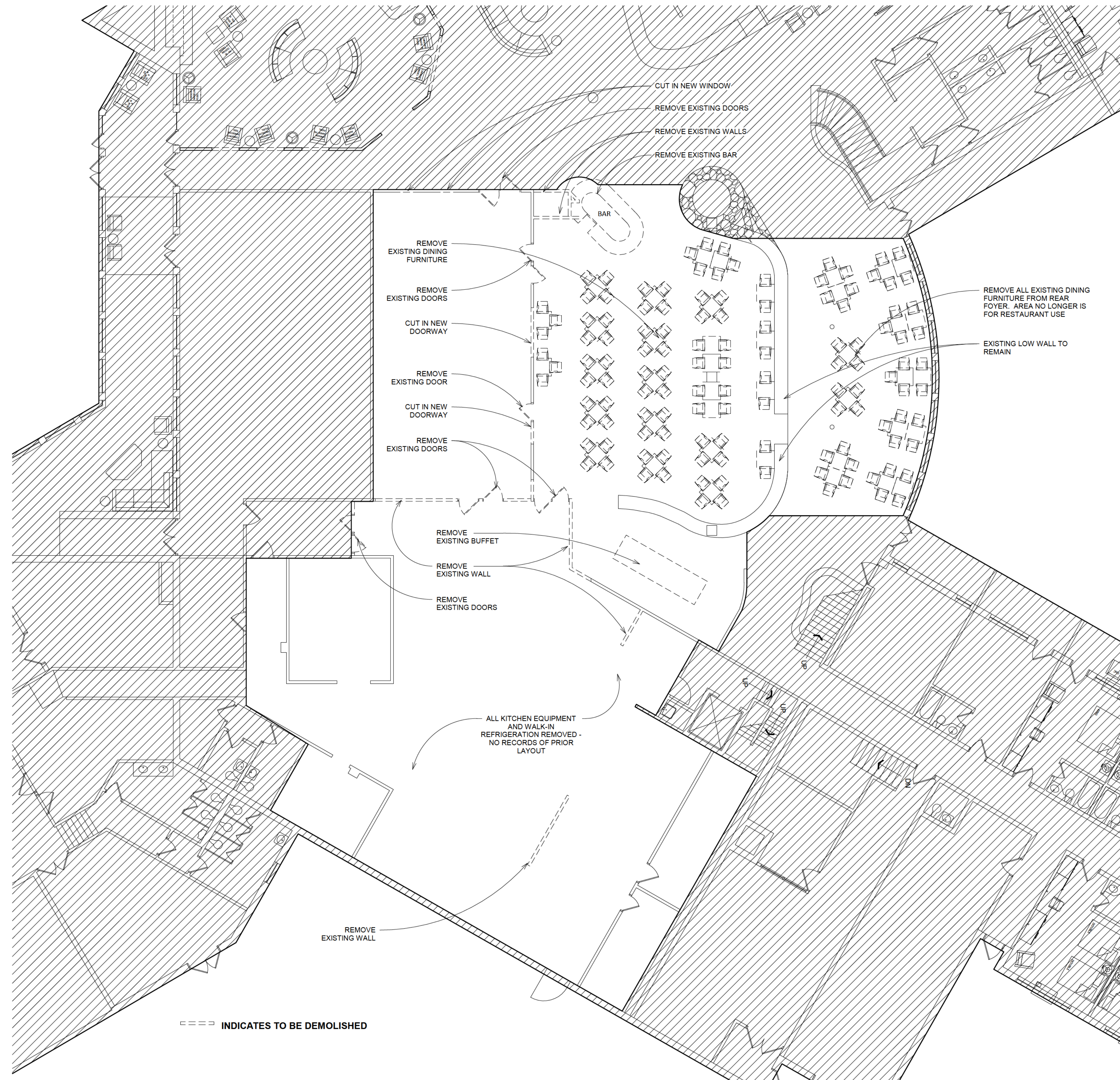

NOTE:

INTEGRATED ARCHITECTURE WAS NOT INVOLVED PRIOR TO OR DURING THE REMODEL OF THE FOGGY BOTTOM KITCHEN RESTAURANT. DRAWINGS AND DOCUMENTS CONSIST OF INFORMATION PROVIDED TO INTEGRATED ARCHITECTURE BY THE STATE OF OKLAHOMA, SWADLEY'S WORLD FAMOUS BAR-B-Q AND ON-SITE VERIFICATION OF CURRENT SITE CONDITIONS ALSO CONTRIBUTED TO INFORMATION SUBMITTED.

INTEGRATED ARCHITECTURE
 www.integratedarc.com
 P.O. Box 7808 Edmond, OK 73078 (405) 255-4243
 CIVIL ENGINEERING

STRUCTURAL ENGINEERING

MEP ENGINEERING

SEQUOYAH STATE PARK
 17131 PARK 10
 HULBERT, OK 74441

CLIENT
 SWADLEY'S WORLD FAMOUS
 BAR-B-Q

PROJECT # 21028

ISSUED BY DRAWN BY / CHECKED BY
 Author Checker

REVISIONS

No.	Description	Date

SEAL 09/10/21

STATE OF OKLAHOMA
 MARK D. GANDY
 3254
 L.L. CREECH
 PERMIT DRAWINGS

SHEET NAME
 PRIOR TO REMODEL /
 DEMOLITION FLOOR
 PLAN

SHEET NUMBER

1 PRIOR / DEMOLITION FLOOR PLAN
 1/8" = 1'-0"

D101

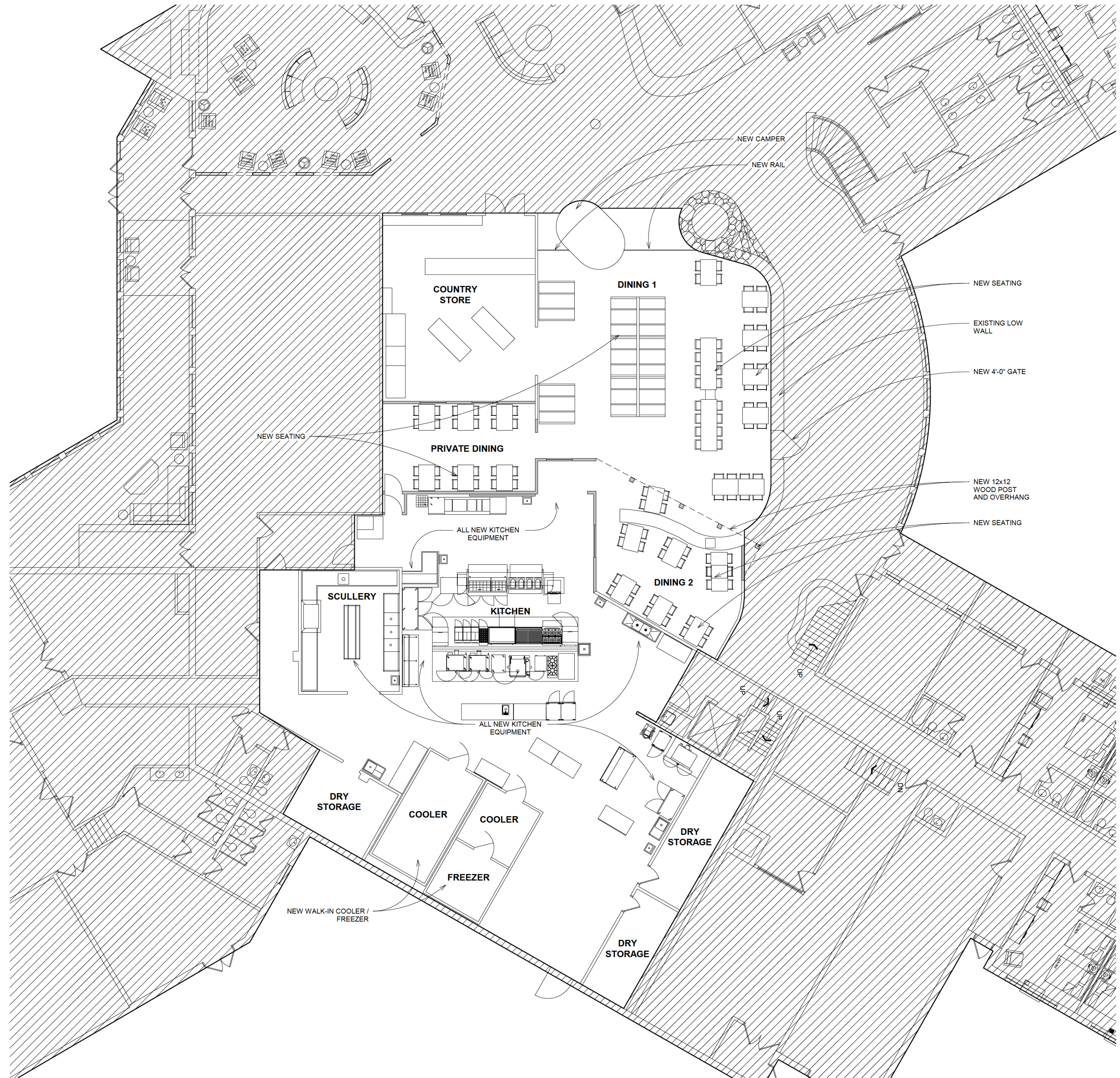

NOTE:
 INTEGRATED ARCHITECTURE WAS NOT INVOLVED PRIOR TO OR DURING THE REMODEL OF THE FOGGY BOTTOM KITCHEN RESTAURANT. DRAWINGS AND DOCUMENTS CONSIST OF INFORMATION PROVIDED TO INTEGRATED ARCHITECTURE BY THE STATE OF OKLAHOMA, SWADLEY'S WORLD FAMOUS BAR-B-Q AND ON-SITE VERIFICATION OF CURRENT SITE CONDITIONS ALSO CONTRIBUTED TO INFORMATION SUBMITTED.

INTEGRATED ARCHITECTURE
 www.integratedarc.com
 P.O. Box 7808 Edmond, OK 73078 (405) 255-4243
 CIVIL ENGINEERING

STRUCTURAL ENGINEERING
 MEP ENGINEERING

SEQUOYAH STATE PARK
 17131 PARK 10
 HULBERT, OK 74441

CLIENT
 SWADLEY'S WORLD FAMOUS BAR-B-Q
 PROJECT # 21028
 ISSUED BY / DRAWN BY / CHECKED BY
 Author Checker

REVISIONS

No.	Description	Date

SEAL 09/10/21
 STATE OF OKLAHOMA
 MARK D. GANDY
 3254
 ISSUED FOR PERMIT DRAWINGS

SHEET NAME
 CURRENT FLOOR PLAN

SHEET NUMBER

1 CURRENT FLOOR PLAN
 1/8" = 1'-0"

A102

