



Awarded Supplier Information

Supplier Name: Evolution Edges dba
Chemung Corp.

Supplier ID #: 0000338755

Supplier Address: PO Box 527

City: Elmira

State: NY

Zip Code: 14902

Contact Person Name: Michael Menner

Phone #: 1-607-733-5506

Title: Manager

Fax #: 1-607-732-5379

Email: mmenner@chemungsupply.com

Website: www.evolutionedges.com

Authorized Location: ☐ Locations list attached as *n/a*

☐ Address:

City:

State:

Zip Code:

Contract ID #: 4344

Delivery: FOB Destination

Minimum Order: n/a

P/Card Accepted: ☒ Yes

☐ No

Other:

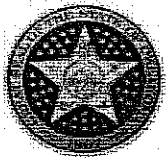

CONTRACT

State of Oklahoma

Dispatch via Print

Supplier 0000338755
 CHEMUNG SUPPLY CORP
 PO BOX 527
 ELMIRA NY 14902
 USA

| | | | | |
|---|--|------------------------|---------------------------------|-----------------------------|
| Contract ID 00000000000000000004344 | | | Page 1 of 3 | |
| Contract Dates 03/14/2016 to 03/13/2017 | | Currency USD | Rate Type CRRNT | Rate Date PO Date |
| Description: | | | Contract Maximum 0.00 | |
| | | | | |
| TYPE: STATEWIDE | | | | |

Tax Exempt? Y Tax Exempt ID:736017987

Contract Lines:

| Line # | Cat CD / Item ID / Item Desc | UOM | Minimum Order | | Maximum / Open | |
|--------|--|-----|---------------|------|----------------|------|
| | | | Qty | Amt | Qty | Amt |
| 1 | 31161627 / Bolt & Nut, 5/8" x 2" grade 8/Dome Brand: Fastenal Brand #F-44782 Price per each: \$1.10 | EA | 1.00 | 0.00 | 0.00 | 0.00 |
| | Contract Base Pricing | | 1.10000 | | | |
| | | EA | | 0001 | | |
| 2 | 31161627 / Bolt & Nut, 5/8" x 2 1/2" grade 8/Dome Brand: Fastenal Brand #F-44784 Price per each: \$1.20 | EA | 1.00 | 0.00 | 0.00 | 0.00 |
| | Contract Base Pricing | | 1.20000 | | | |
| | | EA | | 0001 | | |
| 3 | 31161627 / Bolt & Nut, 5/8" x 3" grade 8/Dome Brand: Fastenal Brand #F-44786 Price per each: \$1.30 | EA | 1.00 | 0.00 | 0.00 | 0.00 |
| | Contract Base Pricing | | 1.30000 | | | |
| | | EA | | 0001 | | |
| 4 | 31161627 / Bolt & Nut, 5/8" x 3 1/2" grade 8/Dome Brand: Fastenal Brand #F-44788 Price per each: \$1.54 | EA | 1.00 | 0.00 | 0.00 | 0.00 |
| | Contract Base Pricing | | 1.54000 | | | |
| | | EA | | 0001 | | |
| 5 | 31161627 / Bolt & Nut, 5/8" x 2" grade 8/Flat Head Brand: Fastenal Brand #F-41575 Price per each: \$1.50 | EA | 1.00 | 0.00 | 0.00 | 0.00 |
| | Contract Base Pricing | | 1.50000 | | | |
| | | EA | | 0001 | | |
| 6 | 31161627 / Bolt & Nut, 5/8" x 2 1/2" grade 8/Flat Head | EA | 1.00 | 0.00 | 0.00 | 0.00 |

Final = The price is final after adjustments
 Hard = Apply adjustments regardless of other adjustments
 Skip = Skip adjustments if any other adjustments have been applied

Authorized Signature

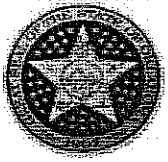

CONTRACT

State of Oklahoma

Dispatch via Print

Supplier 0000338755
CHEMUNG SUPPLY CORP
PO BOX 527
ELMIRA NY 14902
USA

| | | | | |
|--------------------------|--|-------------------------|------------------|------------------|
| Contract ID | | | Page | |
| 000000000000000000004344 | | | 2 of 3 | |
| Contract Dates | | Currency | Rate Type | Rate Date |
| 03/14/2016 to 03/13/2017 | | USD | CRRNT | PO Date |
| Description: | | Contract Maximum | | |
| | | 0.00 | | |
| TYPE: STATEWIDE | | | | |

Tax Exempt? Y Tax Exempt ID:736017987

Contract Lines:

| Line # | Cat CD / Item ID / Item Desc | UOM | Minimum Order Qty | Amt | Maximum / Open Qty | Amt |
|--------|---|-----|-------------------|------|--------------------|------|
| | Brand: Fastenal Brand #F-41577 Price per each: \$1.54 | | | | | |
| | Contract Base Pricing | | 1.54000 | EA | 0001 | |
| 7 | 31161627 / Bolt & Nut, 5/8" x3" grade 8/Flat Head Brand: Fastenal Brand #F-41579 Price per each: \$1.64 | EA | 1.00 | 0.00 | 0.00 | 0.00 |
| | Contract Base Pricing | | 1.64000 | EA | 0001 | |
| 8 | 31161627 / Bolt & Nut, 5/8" x 3 1/2" grade 8/Flat Head Brand: Fastenal Brand #F-41581 Price per each: \$1.78 | EA | 1.00 | 0.00 | 0.00 | 0.00 |
| | Contract Base Pricing | | 1.78000 | EA | 0001 | |
| 9 | 22101703 / BLADE: carbide insert 3/4" x 6" x 36" There are two insert choices for this line. They are both 3 feet long and have been priced per ea. There are drawings on the website where the statewide contract that show the difference between the two types of insert blades. The Brand is Evolution Edges. For the 3/4 inch x 6 inch Carbide insert blades with .635" 25 degrees trapezoid inserts: The price per ea 3 foot length is \$121.32 For the 3/4 inch x 6 inch Carbide insert blades with .75" 25 degree trapezoid inserts: The price per ea 3 foot length is \$148.57. | EA | 1.00 | 0.00 | 0.00 | 0.00 |
| | Contract Base Pricing | | 0.01000 | EA | 0001 | |
| 10 | 22101703 / BLADE: carbide insert BLADE: carbide insert 3/4" x 6" x 48" | EA | 1.00 | 0.00 | 0.00 | 0.00 |

Final = The price is final after adjustments
Hard = Apply adjustments regardless of other adjustments
Skip = Skip adjustments if any other adjustments have been applied

Authorized Signature



CONTRACT

State of Oklahoma

Dispatch via Print

Supplier 0000338755
CHEMUNG SUPPLY CORP
PO BOX 527
ELMIRA NY 14902
USA

| | | | | |
|--|--|------------------------|---------------------------------|-----------------------------|
| Contract ID 0000000000000000000000004344 | | | Page 3 of 3 | |
| Contract Dates 03/14/2016 to 03/13/2017 | | Currency USD | Rate Type CRRNT | Rate Date PO Date |
| Description: | | | Contract Maximum 0.00 | |
| TYPE: STATEWIDE | | | | |

Tax Exempt? Y Tax Exempt ID:736017987

Contract Lines:

| Line # | Cat CD / Item ID / Item Desc | UOM | Minimum Order Qty | Order Amt | Maximum / Open Qty | Open Amt |
|--------|--|----------|-------------------|-----------|--------------------|----------|
| | <p>There are two insert choices for this line. They are both 4 feet long and have been priced per ea.</p> <p>There are drawings on the website where the statewide contract that show the difference between the two types of insert blades. The Brand is Evolution Edges.</p> <p>For the 3/4 inch x 6 inch Carbide insert blades with .635" 25 degrees trapezoid inserts: The price per each 4 foot length is \$161.76.</p> <p>For the 3/4 inch x 6 inch Carbide insert blades with .75" 25 degree trapezoid inserts: The price per each 4 foot length is \$158.45.</p> | | | | | |
| | Contract Base Pricing | 0.01000 | EA | 0001 | | |
| 11 | 22101703 / Grader Blade, Curved Double Bevel Standard punch. 5/8" x 6" Priced per foot. \$7.92. | FT | 1.00 | 0.00 | 0.00 | 0.00 |
| | Contract Base Pricing | 7.92000 | FT | 0001 | | |
| 12 | 22101703 / Grader Blade, Curved Double Bevel Standard punch. 5/8" x 8" Priced per foot. \$10.88. | FT | 1.00 | 0.00 | 0.00 | 0.00 |
| | Contract Base Pricing | 10.88000 | FT | 0001 | | |
| 13 | 22101703 / Grader Blade, Curved double bevel. Standard punch. 3/4" x 8" Priced per foot. \$13.15. | FT | 1.00 | 0.00 | 0.00 | 0.00 |
| | Contract Base Pricing | 13.15000 | FT | 0001 | | |
| 14 | 22101703 / Plow blade, Standard punch 12" punch w/sq 11/16" 1/2" x 6". Priced per foot. \$7.02. | FT | 1.00 | 0.00 | 0.00 | 0.00 |
| | Contract Base Pricing | 7.02000 | FT | 0001 | | |

COMMENTS:

Final = The price is final after adjustments
Hard = Apply adjustments regardless of other adjustments
Skip = Skip adjustments if any other adjustments have been applied

Authorized Signature

CONTACT INFORMATION FOR:

Website:

| | |
|--|---|
| Company Name | Evolution Edges |
| Doing Business as (if applicable) | Chemung Supply Corp. |
| Contact Person for Solicitation Response | Michael Menner |
| Phone | 607-733-5506 |
| Email | mmenner@chemungsupply.com |
| Address For Purchase Orders-Number & Street-Post Office Box (some companies have ordering addresses that are different than the payment address) | PO Box 527 Elmira, NY 14902 |
| City, State, Zip | |
| Contact Person for Contract/Ordering/Price Information/Equipment Additions/Changes/Discontinuations | Michael Menner |
| Phone | 607-733-5506 |
| Fax | 607-732-5379 |
| Email | mmenner@chemungsupply.com |
| Secondary Contact for Contract/Ordering | Marc P. Stemerman |
| Phone | 607-733-5506 |
| Fax | 607-732-5379 |
| Email | mstemerman@chemungsupply.com |
| Address For Payment-Number & Street-Post Office Box (some companies have a different Payment/remittance address than the ordering address) | same |
| City, State, Zip | |
| Contact Person/Department for payment | same |
| Phone | |
| Fax | |
| Email | |
| | |
| | |
| | |
| | |
| | |
| Payment Discount (i.e. 15 days) | Net _____ days |
| Supplier will be responsible for notifying the contracting officer when the contact information changes for ordering and payment. | Notes: (Special ordering instructions-please attach any special instructions on a separate sheet) |

CHEMUNG SUPPLY
P.O. Box 527
Elmira, NY 14902

| Grader/Plow blades | Size | Brand | Brand # | Price per each | | | |
|--------------------|--------------------------------------|-----------|---------|-----------------|----------------|--------------|----------------|
| Bolt & Nut | 5/8" x 2" grade 8/Dome | FASTENAL | F-44782 | \$1.10 | | | |
| Bolt & Nut | 5/8" x 2 1/2" grade 8/Dome | FASTENAL | F-44784 | \$1.20 | | | |
| Bolt & Nut | 5/8" x 3" grade 8/Dome | FASTENAL | F-44786 | \$1.30 | | | |
| Bolt & Nut | 5/8" x 3 1/2" grade 8/Dome | FASTENAL | F-44788 | \$1.54 | | | |
| Bolt & Nut | 5/8" x 2" grade 8/Flat Head | FASTENAL | F-41575 | \$1.50 | | | |
| Bolt & Nut | 5/8" x 2 1/2" grade 8/Flat Head | FASTENAL | F-41577 | \$1.54 | | | |
| Bolt & Nut | 5/8" x 3" grade 8/Flat Head | FASTENAL | F-41579 | \$1.64 | | | |
| Bolt & Nut | 5/8" x 3 1/2" grade 8/Flat Head | FASTENAL | F-41581 | \$1.78 | | | |
| | | | | Brand | Brand # | Price | (EA/FT) |
| Carbide plow blade | | 3/4" x 6" | 3' | EVOLUTION EDGES | | \$121.32 | EA |
| Carbide plow blade | | 3/4" x 6" | | EVOLUTION EDGES | | \$148.57 | EA |
| Carbide plow blade | | 3/4" x 6" | 4' | EVOLUTION EDGES | | \$161.76 | EA |
| Carbide plow blade | | 7/8" x 5" | | EVOLUTION EDGES | | \$158.45 | EA |
| Carbide plow blade | Dual-carbide | 7/8" x 5" | 3' | | | NO BID | |
| Carbide plow blade | Dual-carbide | 7/8" x 5" | 4' | | | NO BID | |
| Grader Blade | Curv dbl Bev. Stand punch. | 5/8" x 6" | | | | \$7.92 | PER FT |
| Grader Blade | Curv dbl Bev. Stand punch. | 5/8" x 8" | | | | \$10.88 | PER FT |
| Grader Blade | Curv dbl Bev. Stand punch. | 5/8" x 8" | | | | \$10.88 | PER FT |
| | | | | | | | |
| Grader Blade | | 7/8" x 5" | | | | NO BID | |
| Grader Blade | Dual-carbide | 7/8" x 5" | 3' | | | NO BID | |
| Grader Blade | Dual-carbide | 7/8" x 5" | 4' | | | NO BID | |
| Grader Blade | | 7/8" x 5" | 36" | | | NO BID | |
| Grader Blade | | 7/8" x 5" | 36" | | | NO BID | |
| Grader Blade | | 7/8" x 5" | 48" | | | NO BID | |
| Grader Blade | | 7/8" x 5" | 48" | | | NO BID | |
| Grader Blade | Sgl Bev Dual Carb | 3/4" x 6" | | | | NO BID | |
| Grader Blade | Curv dbl Bev. Stand punch. | 3/4" x 8" | | | | \$13.15 | PER FT |
| Grader Blade | Curv dbl Bev. Stand punch. | 3/4" x 8" | | | | \$13.15 | PER FT |
| | | | | | | | |
| Plow Blade | stand punch 12" punch w/sq 11/16" | 1/2"x6" | | | | \$7.02 | PER FT |
| Plow Blade | stand punch 12" punch w/sq 11/16" | 1/2"x6" | | | | \$7.02 | PER FT |

GRADER BLADES

High carbon blades steel producing the following analysis:

| | |
|--------------|-------------|
| Carbon: | .80 - .93 |
| Manganese | .60 - .90 |
| Phosphorous: | .04 maximum |
| Sulfur: | .05 maximum |
| Silicon: | .35 maximum |

| <u>DESCRIPTION:</u> | <u>MINIMUM REQUIREMENTS</u> | <u>VENDOR'S PROPOSAL</u> |
|--------------------------------|--|---------------------------------|
| <u>Grader Blade:</u> | Standard punching, 5/8" x 8" curved double bevel, weight per ft 15.6 lb. (Specify lengths 6', 7', 8', 9') | <u>\$10.88/ft.</u> |
| <u>Grader Blade:</u> | Standard punching, 5/8" x 6" curved double bevel, weight per ft 11.7 lb. (Specify lengths 6', 7', 8', 9') | <u>\$7.92/ft</u> |
| <u>Grader Blade:</u> | Standard punching, 3/4" x 8" curved double bevel, weight per ft 18.4 lb. (Specify lengths 6', 7', 8', 9') | <u>\$13.15/ft</u> |
| <u>Snow Plow Blade:</u> | Standard punching, snow plow blades, 1/2" x 6" flat, square edged, weight per ft 10.27 lb. (Specify lengths 10', 11', 12') | <u>\$7.02/ft.</u> |

WARRANTY: One Year / From Date of Delivery

SPECIFICATIONS:

Each Bidder shall submit complete manufacturer's specification in duplicate and shall submit all other data to show that his proposal meets these specifications.

THE STATE OF OKLAHOMA RESERVES THE RIGHT TO WAIVE MINOR TECHNICALITIES UNDER THESE SPECIFICATIONS.

COMPLIANCE:

Bidder Shall furnish a statement in writing on the Bid or by attached letter, and in the Vendor's Statement below, if his equipment proposed strictly meets these Specifications. If not, he shall list each variation therefrom.

INSPECTION AND DELIVERY OF EQUIPMENT MUST COMPLY WITH VENDOR'S INSTRUCTION SHEET.

SPECIAL REQUIREMENTS:

Successful bidder will provide at no additional cost a technical representative to instruct the receiving divisions in the proper care, maintenance, and operation of the machine.

VENDOR'S STATEMENT: (Equipment Proposed Complies:) **YES:** ^x **NO:** _____

DEALER: Chemung Supply Corp. **DATE:** 2/17/16

SIGNATURE:  **PHONE:** 607-733-5506
Michael Menner

ADDRESS: PO Box 527 Elmira, NY 14902

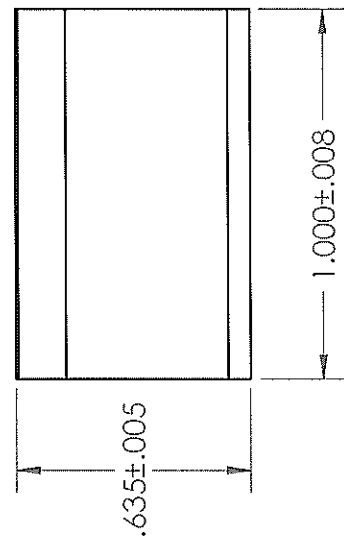
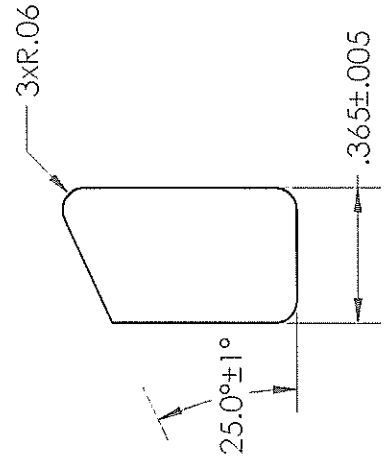
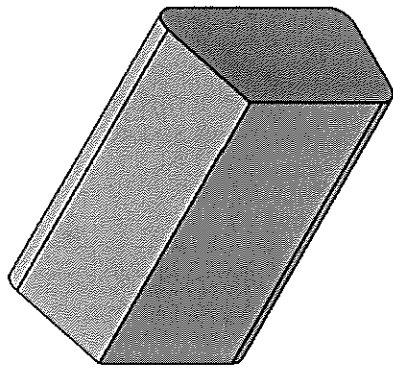

NOTE:
GRADE: YG10CB
COLBALT: 11-12.5%
BALANCE: WC
DENSITY: 14.1-14.6G/CC
HARDNESS: 87.0-89.0HRA
TRS: 350000 PSI
POROSITY: A04,B02,C00

PROPRIETARY AND CONFIDENTIAL
THE INFORMATION CONTAINED IN THIS
DRAWING IS THE SOLE PROPERTY OF
<INSERT COMPANY NAME HERE>. ANY
REPRODUCTION IN PART OR AS A WHOLE
WITHOUT THE WRITTEN PERMISSION OF
<INSERT COMPANY NAME HERE> IS
PROHIBITED.



| UNLESS OTHERWISE SPECIFIED: | | NAME | DATE |
|--------------------------------------|--|------------|-----------|
| DIMENSIONS ARE IN INCHES | | R. JOHNSON | 8/20/2012 |
| TOLERANCES: | | DRAWN | CHECKED |
| FRACTIONAL ± 1/16 | | | ENG APPR. |
| ANGULAR: MACH ± .1 BEND ± .5 | | | MFG APPR. |
| TWO PLACE DECIMAL ± .03 | | | Q.A. |
| THREE PLACE DECIMAL ± .01 | | | COMMENTS: |
| INTERPRET GEOMETRIC TOLERANCING PER: | | | |
| MATERIAL | | | |
| FINISH | | | |

NEXT ASSY
USED ON

SEE NOTE

APPLICATION

TITLE: 5/8 INSERT 1.0
SIZE DWG. NO. REV
A C1365635125 A
SCALE: 4:1 WEIGHT: SHEET 1 OF 1

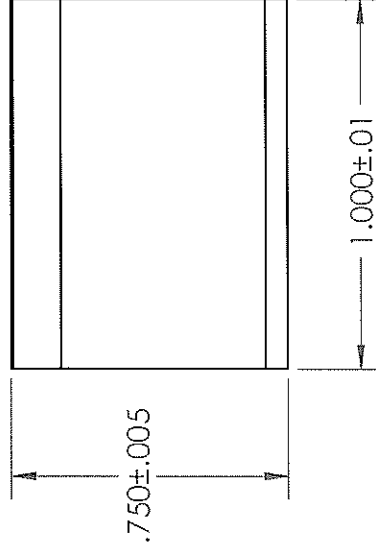
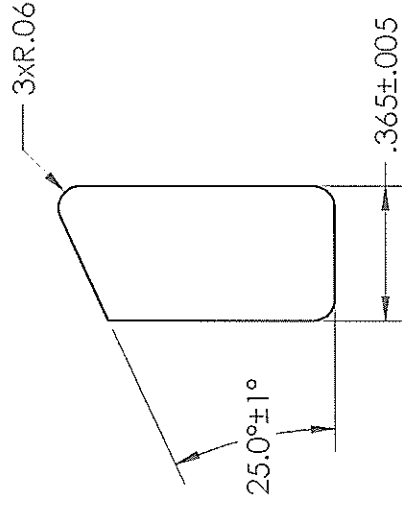
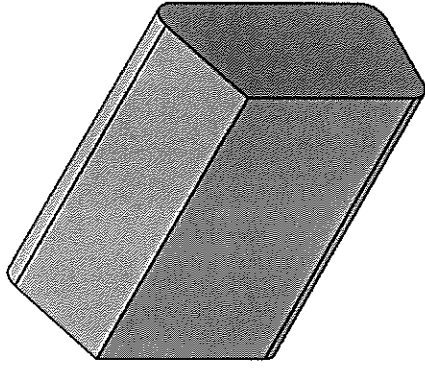

NOTE:
GRADE: YG10CB
COLBALT: 11-12.5%
BALANCE: WC
DENSITY: 14.1-14.6G/CC
HARDNESS: 87.0-89.0HRA
TRS: 350000 PSI
POROSITY: A04,B02,C00

PROPRIETARY AND CONFIDENTIAL
THE INFORMATION CONTAINED IN THIS
DRAWING IS THE SOLE PROPERTY OF
<INSERT COMPANY NAME HERE>. ANY
REPRODUCTION IN PART OR AS A WHOLE
WITHOUT THE WRITTEN PERMISSION OF
<INSERT COMPANY NAME HERE> IS
PROHIBITED.



| UNLESS OTHERWISE SPECIFIED: | NAME | DATE |
|--------------------------------------|------------|-----------|
| DIMENSIONS ARE IN INCHES | R. JOHNSON | 8/20/2012 |
| TOLERANCES: | DRAWN | CHECKED |
| FRACTIONAL ± 1/16 | ENG APPR. | MFG APPR. |
| ANGULAR: MACH ± .1 BEND ± .5 | Q.A. | COMMENTS: |
| TWO PLACE DECIMAL ± .03 | | |
| THREE PLACE DECIMAL ± .01 | | |
| INTERPRET GEOMETRIC TOLERANCING PER: | | |
| MATERIAL | | |
| FINISH | | |

SEE NOTE

NEXT ASSY USED ON

APPLICATION

3/4 INSERT 1.0
SIZE DWG. NO. REV
A C1365750125 A

SCALE: 4:1 WEIGHT: SHEET 1 OF 1