

- 1A AOL
- 1A-1 FEMA
- 1B Harrington - United Health
- 1C OIG
- 1D OU Care
- 1F Mental Health
- 1G Mental Health
- 2 Farmers Group
- 2B Farmers Group
- 2C EDS - Expansion
- 2D Vacant
- 3 ASTEC Charter School
- 4 Fire Marshal
- 5 Construction Industries Board
- 11 EDS
- 12 U.S. Post Office
- 14 ATI
- 17 Geriatric Care
- 18 Real Estate Commission
- 20 SSA
- 21 Dept of Rehab
- 24 Dentist
- 28 Insurance Dept
- 39 Auditors
- 40 Aging Services
- 40B Activity Center
- 41 H & R Block
- 42 Assistant Receivers
- 45 DPS
- 47 Dept of Rehab
- 49 FIG Credit Union
- 51 Rehab Services
- 62 Security
- 55 Vacant
- 57 Used Motor Vehicles
- 59 Rehab Services
- 60 Oklahoma Credit Union
- 60B Abstractors Board
- 61 Beijing
- 61A Los Moranos Cafe
- 62 Board of Nursing
- 64 Dizzy's
- 65 Rehab Services
- 69 Subway
- 70 WNC
- 71 Mail Office
- 72 ATI Expansion
- 74 DHS Disabilities
- 75 OU Care Expansion
- 78 Mental Health
- 78 Horse Racing Commission
- 82 Mental Health
- 84 Cosmetology
- 85 Mental Health
- 87ATI Expansion
- 88 ODOT
- 90 Handicap Consens
- 91 Rehab Services
- 100 Indep. Careers Expansion
- 101 Independent Careers
- 103 B&M Cleaners
- 104 Pizzaria
- 105 Vacant

Shepherd Mall Office Complex

Site Plan

June, 2009

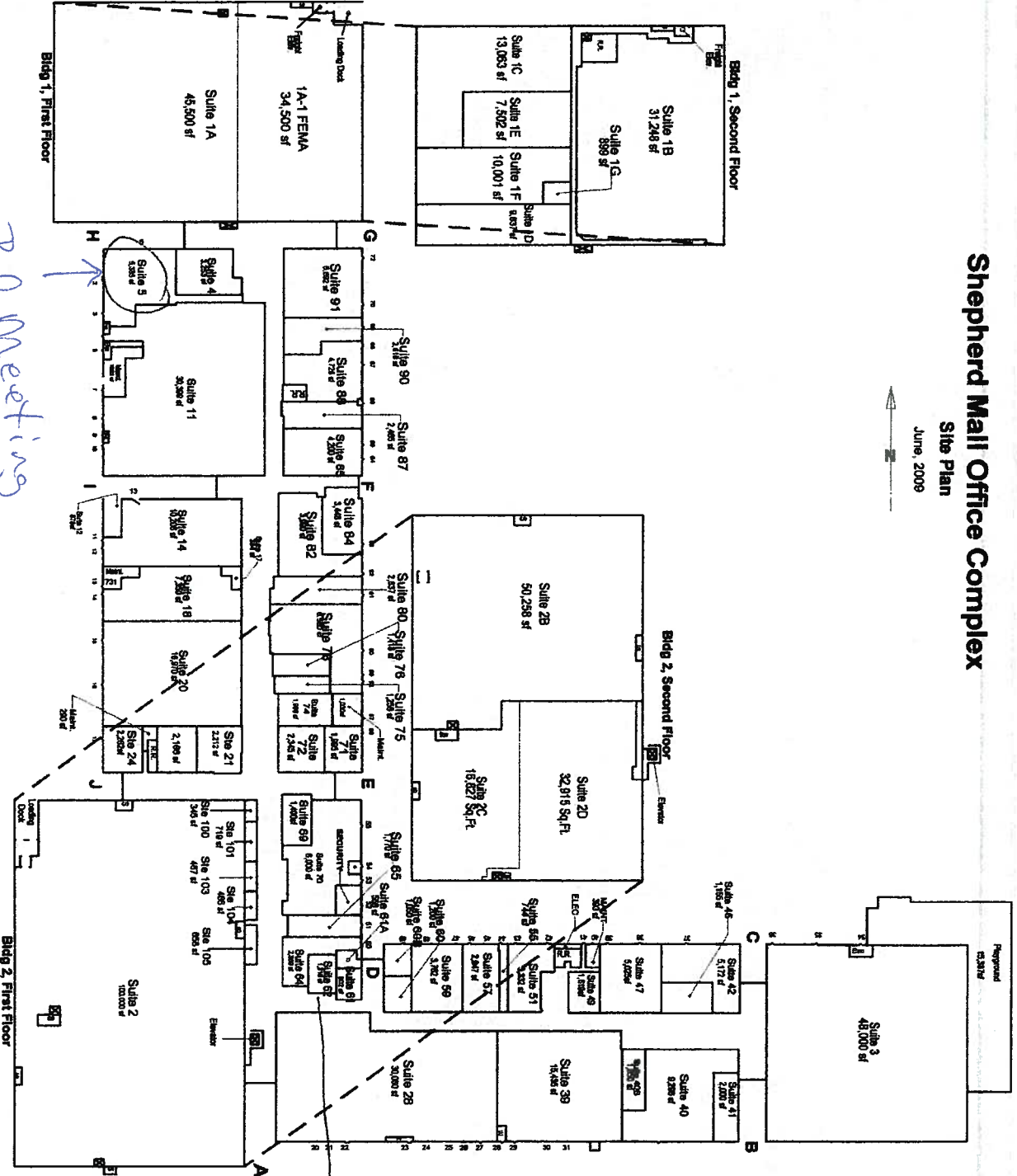

BD Meeting Location

BD Office

North Villa Ave.

N.W. 23rd St.